

Brončane navojne spojnice

Cjevovodna tehnika

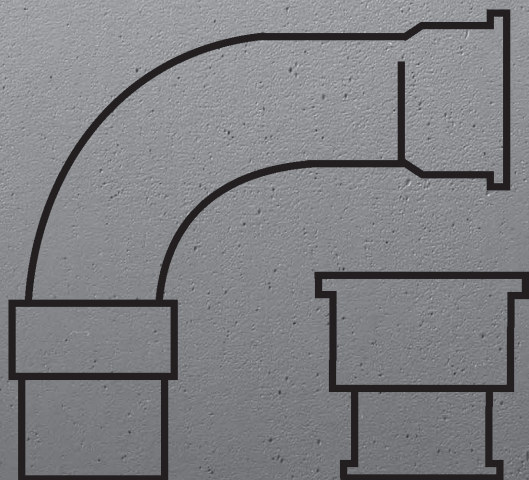

viega

Brončane navojne spojnice s golom ili kromiranom površinom.

Oznaka

Proizvođač, dimenzija cijevi, šarža

Brtveni elementi

Vanjski R-navoj tvornički ohrapavljen – moguće postavljanje kudjelje bez grube obrade navoja.

Dimenzije

1/6–4

Uputa - norme i certifikati

Brončani navojni fitinzi prema normi DIN EN 10226, dio 1, certificirani za instalacije pitke vode prema normi DIN 1988 i za plinske instalacije prema DVGW-TRGI 2018 (radni list DVGW G 600) (imajte u vidu upute na pojedinačnim modelima), ispitano prema DVGW radnim listovima GW 6 i GW 393.

Dozvola za brončane navojne fittinge prema DVGW reg. br. DV-7401AO2957.

Materijali press spojnica

Bronca: CC499K

Silicijeva bronca: CC246E / CuSi4Zn9MnP

Pridržavamo pravo na izmjene i pogreške!

Važeće Z-dimenzije i ugradbene dimenzije kao i daljnji tehnički podaci moraju se preuzeti sa internetske stranice poduzeća Viega i provjeriti prije kupnje, kod projektiranja, ugradnje ili korištenja. Naši proizvodi kontinuirano se optimiraju.

Ovaj opis proizvoda sadrži važne informacije o izboru proizvoda odn. sustava, o montaži i puštanju u rad, kao i o namjenskom korištenju i, ako je potrebno, o mjerama održavanja. Ove informacije o proizvodima, njihovim svojstvima i tehnikama primjene zasnivaju se na aktualno važećim normama u Europi (npr. EN) i/ili u Njemačkoj (npr. DIN/DVGW). Pojedini odlomci u tekstu mogu upućivati na tehničke propise u Europi/Njemačkoj. One bi za druge zemlje trebale važiti kao preporuke, ukoliko tamo ne postoje nikakvi odgovarajući nacionalni zahtjevi. Dotični nacionalni zakoni, standardi, propisi, norme, kao i drugi tehnički propisi imaju prednost pred njemačkim/europskim smjernicama ovog opisa proizvoda: ovdje prikazane informacije nisu obvezujuće za druge zemlje i područja te ih treba shvatiti kao podršku.

SADRŽAJ

Artikli od bronce

Lukovi, koljena	4
Zidne pločice	5
T-komadi, spojnice	6
Spojnice, prijelazi, Produljenja	7
Navojne spojnice, kape, pribornice	13

Artikli od mesinga

Čepovi	17
--------	----

Kromirane spojnice

Lukovi, koljena	18
Zidne pločice	19
T-komadi, spojnice	20
Spojnice, prijelazi	20
Čepovi	24
Dvostruki priključni komadi	24
Spojnica za crijevo	25

GTIN-kod (Global Trade Item Number, prije EAN)

GTIN broj sastoji se od fiksne šifre proizvođača 4015211 i dotičnog šesteroznamenkastog broja artikla, u ovom primjeru 305 611. Zamjena zadnjih šest mjesta u oznaci brojem artikla daje GTIN-kod.

**ARTIKLI OD BRONCE
LUKOVI, KOLJENA**

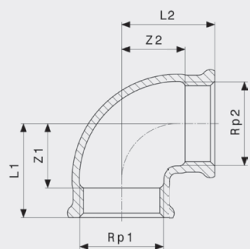

**Koljeno 90°
- bronca
Model 3090**

Artikl	Rp1	Rp2	Z1	Z2	L1	L2
441 074	1/8	1/8	15	15	23	23
317 959	1/4	1/4	7	7	18	18
281 717	3/8	3/8	12	12	24	24
269 272	1/2	1/2	15	15	30	30
320 676	1/2	3/8	9	14	24	26
269 258	3/4	3/4	13	13	30	30
320 669	3/4	1/2	11	15	27	30
269 234	1	1	18	18	38	38
320 683	1	3/4	14	20	33	36
269 210	1 1/4	1 1/4	29	29	50	50
269 197	1 1/2	1 1/2	33	33	54	54
269 296	2	2	37	37	63	63
321 796	2 1/2	2 1/2	42	42	72	72
650 698	3	3	49	49	82	82

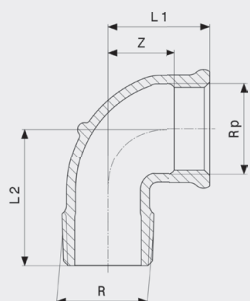

**Koljeno 90°
- bronca
Model 3092**

Artikl	R	Rp	Z	L1	L2
318 000	1/4	1/4	7	18	29
281 748	3/8	3/8	17	29	32
264 024	1/2	1/2	9	24	34
264 000	3/4	3/4	10	26	38
264 048	1	1	13	32	47
264 109	1 1/4	1 1/4	21	43	51
264 123	1 1/2	1 1/2	39	60	59
264 147	2	2	32	58	79
321 710	2 1/2	2 1/2	35	65	90
650 704	3	3	49	82	100

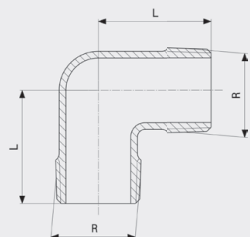

**Koljeno 90°
- bronca
Model 3091**

Artikl	R	L
317 966	3/8	29
317 973	1/2	32
317 980	3/4	40
317 997	1	45

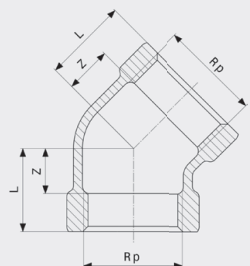

**Koljeno 45°
- bronca
Model 3120**

Artikl	Rp	Z	L
318 048	3/8	8	19
320 690	1/2	7	22
320 645	3/4	9	25
320 652	1	9	28
650 728	2	14	40

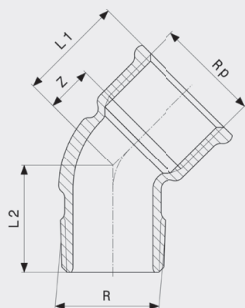

Koljeno 45°
- bronca
Model 3121

Artikl	R	Rp	Z	L1	L2
281 755	3/8	3/8	10	22	23
264 208	1/2	1/2	8	23	31
264 185	3/4	3/4	13	30	31
264 161	1	1	15	34	35
448 271	1 1/4	1 1/4	24	45	40
448 288	1 1/2	1 1/2	26	47	45
650 711	2	2	26	52	56

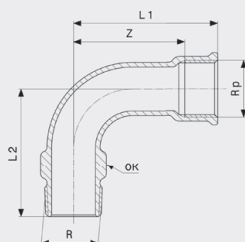

Koljeno 90°
- bronca
Model 3001

Artikl	R	Rp	Z	L1	L2	OK
294 571	1	1	66	85	75	36
294 595	1 1/4	1 1/4	84	105	95	44
294 618	1 1/2	1 1/2	84	105	105	51

OK = otvor ključa

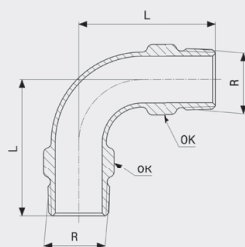

Koljeno 90°
- bronca
Model 3003

Artikl	R	L	OK
294 632	1	75	36
294 656	1 1/4	95	44

OK = otvor ključa

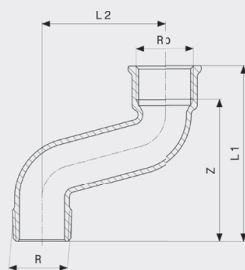

S koljeno
- bronca
Model 3004

Artikl	R	Rp	Z	L1	L2
296 667	1	1	81	100	70
296 643*	1 1/4	1 1/4	94	115	80

* = Isporuka samo još iz zaliha na skladištu

**ARTIKLI OD BRONCE
ZIDNE PLOČICE**

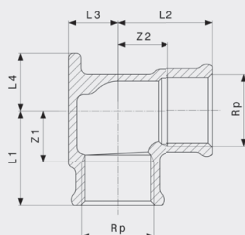

Zidna pločica
- bronca
Model 3471

Artikl	Rp	Z1	Z2	L1	L2	L3	L4
259 778	1/2	21	16	36	31	14	21
441 449	3/4	19	19	35	35	18	21

ARTIKLI OD BRONCE
T-KOMADI, SPOJNICE

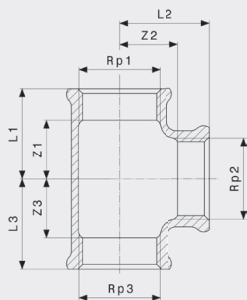

T-komad
- bronca
Model 3130

Artikl	Rp1	Rp2	Rp3	Z1	Z2	Z3	L1	L2	L3
441 081	1/8	1/8	1/8	15	15	15	23	23	23
318 017	1/4	1/4	1/4	7	7	7	18	18	18
281 809	3/8	3/8	3/8	15	15	15	23	23	23
264 222	1/2	1/2	1/2	11	11	11	26	26	26
264 444	1/2	3/8	1/2	15	15	15	30	26	30
264 246	3/4	3/4	3/4	13	13	13	30	30	30
362 492	3/4	1/2	1/2	13	11	11	29	26	26
264 468	3/4	1/2	3/4	12	16	12	29	31	29
362 508	3/4	3/4	1/2	14	14	11	30	30	26
264 260	1	1	1	17	17	17	36	36	36
362 515	1	1/2	1	11	15	11	30	30	30
264 420	1	3/4	1	17	20	17	36	36	36
362 522	1	1	1/2	18	18	17	37	37	32
264 284	1 1/4	1 1/4	1 1/4	24	24	24	45	45	45
650 735	1 1/4	1/2	1 1/4	13	21	13	34	36	34
650 742	1 1/4	3/4	1 1/4	16	23	16	37	39	37
264 307	1 1/2	1 1/2	1 1/2	33	33	33	54	54	54
650 759	1 1/2	1/2	1 1/2	13	25	13	34	40	34
650 766	1 1/2	3/4	1 1/2	16	26	16	37	42	37
264 321	2	2	2	35	35	35	61	61	61
650 773	2	1	2	19	32	19	45	51	45
321 734	2 1/2	2 1/2	2 1/2	38	38	38	69	69	69
321 727	3	3	3	52	52	52	85	85	85

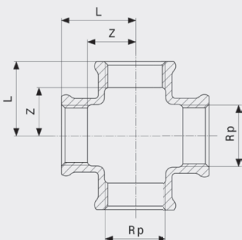

Križni komad
- bronca
Model 3180

Artikl	Rp	Z	L
318 024	3/8	10	21
320 614	1/2	12	27
320 621	3/4	16	32
320 638	1	19	38

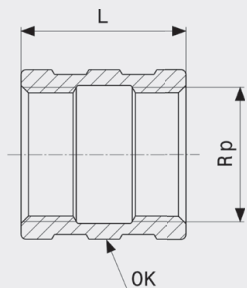

Spojnica
- bronca
Model 3270

Artikl	Rp	VCR	L	OK
441 395	1/8		16	14
319 137	1/4		18	17
282 349	3/8		23	21
266 585	1/2		30	26
266 554	3/4		33	32
266 561	1		38	38
266 578	1 1/4		43	50
267 766	1 1/2		43	57
267 780	2		59	70
271 916	2 1/2		61	83
271 930	3		67	103

VCR = kromirano
OK = otvor ključa

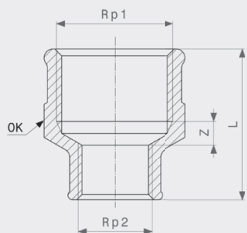

Reducir spojnica
- bronca
Model 3240

Artikl	Rp1	Rp2	VCR	Z	L	OK
282 103	3/8	1/4		3	26	21
318 031	1/2	1/4		5	31	26
268 879	1/2	3/8		5	31	26
266 370	3/4	3/8		5	34	31
268 862	3/4	1/2		5	32	31
266 363	1	1/2		13	34	26
266 356	1	3/4		7	36	38
266 431	1 1/4	3/4		8	45	47
266 417	1 1/4	1		6	49	47
271 879	1 1/2	3/4		10	41	53
267 520	1 1/2	1		8	48	53
266 394	1 1/2	1 1/4		5	47	53
271 893	2	1 1/4		2	50	66
267 544	2	1 1/2		0	47	66
271 855	2 1/2	2		16	58	83
650 780	3	2 1/2		27	67	

VCR = kromirano
OK = otvor ključa

ARTIKLI OD BRONCE
SPOJNICE, PRIJELAZI, PRODULJENJA

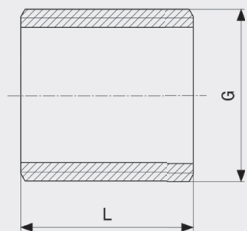

Spojnica
- bronca
Model 3531

Artikl	G	L
322 076	1/4	20
322 113	3/8	20
322 106	1/2	22
322 090	3/4	26
322 083	1	33
322 144	1 1/4	37
322 137	1 1/2	42
322 120	2	47

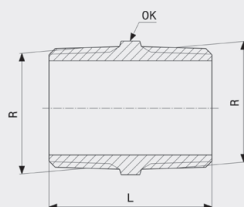

Dvostruka spojnica

- bronca
Model 3280

Artikl	R	VCR	L	OK
441 401	1/8		18	10
320 416	1/4		20	14
282 356	3/8		29	18
266 592	1/2		37	22
266 615	3/4		40	27
266 608	1		45	34
269 135	1 1/4		53	44
269 111	1 1/2		52	50
269 098	2		65	65
321 741	2 1/2		78	80
321 789	3		85	95

VCR = kromirano
OK = otvor ključa

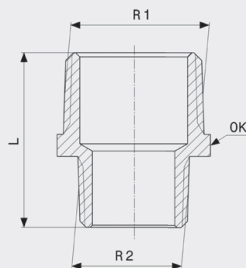

Redukcija

- bronca
Model 3245

Artikl	R1	R2	L	OK
441 364	1/4	1/8	24	14
282 127	3/8	1/4	28	18
319 526	1/2	1/4	31	22
266 530	1/2	3/8	32	22
319 113	3/4	3/8	34	27
266 523	3/4	1/2	37	27
320 287	1	1/2	40	34
266 547	1	3/4	42	34
320 119	1 1/4	3/4	46	44
269 173	1 1/4	1	49	44
321 697	1 1/2	1	52	50
269 159	1 1/2	1 1/4	54	50
441 371	1 3/4	1 1/2	47	55
320 270	2	1 1/4	58	61
321 680	2	1 1/2	59	61
650 803	2 1/2	2	70	76
443 177	3	2 1/2	77	90

OK = otvor ključa

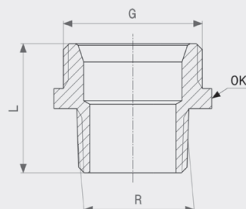

Redukcija

- bronca
Model 3246

Artikl	R	G	VCR	L	OK
441 517	3/8	1/2		25	22
449 339	1/2	1/2		30	22
441 524	1/2	3/4		21	27
449 346	3/4	3/4		33	28
446 765	1/2	1		33	34
441 531	3/4	1		35	34
446 772	1	1		39	34
446 789	1	1 1/4		39	44
446 796	1 1/4	1 1/2		45	50
446 802	1 1/2	1 3/4		47	55
441 388	2	2 3/8		54	71

VCR = kromirano
OK = otvor ključa

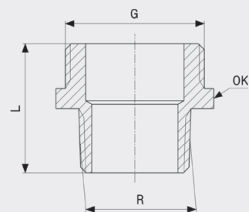

Redukcija
- bronca
Model 3247

Artikl	R	G	VCR	mlk	L	OK
458 775	1/8	1/4			20	14
458 782	1/4	3/8			24	18
458 799	1/4	1/2			25	22
458 805	3/8	1/2			24	27
458 812	3/8	3/4			28	27
446 833	1/2	3/4			31	27
458 829	1/2	1			30	34
446 840	3/4	1			35	34
458 836	3/4	1 1/4			37	44
446 857	1	1 1/4			36	44
458 843	1	1 1/2			43	50
446 864	1 1/4	1 1/2			45	50
458 850	1 1/2	2			48	68

VCR = kromirano
mlk = s unutarnjim konusom
OK = otvor ključa

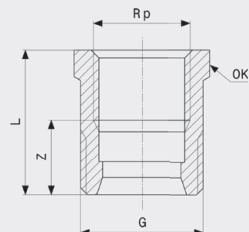

Redukcija
- bronca
Model 3243

Artikl	G	Rp	mlk	Z	L	OK
441 487	3/8	1/4	✓	11	22	18
446 666	1/2	3/8	✓	12	23	22
441 494	3/4	1/2	✓	16	31	27
446 673	1	3/4	✓	16	33	34
449 315	1	1	✓	21	41	40
446 680	1 1/4	1	✓	15	34	43
446 697	1 1/2	1 1/4	✓	18	39	50

mlk = s unutarnjim konusom
OK = otvor ključa

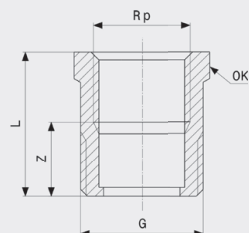

Redukcija
- bronca
Model 3244

Artikl	G	Rp	VCR	mlk	Z	L	OK
446 734	3/4	1/2			14	29	27
446 741	1	3/4			16	33	34
446 758	1 1/4	1			15	34	43

VCR = kromirano
mlk = s unutarnjim konusom
OK = otvor ključa

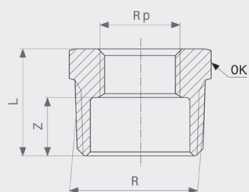

Redukcija
- bronca
Model 3241

Artikl	R	Rp	VCR	Z	L	OK
441 104	¼	⅙		9	17	14
441 111	⅝	⅙		10	17	18
281 823	⅝	¼		6	17	18
441 098	½	⅙		14	21	22
319 076	½	¼		11	22	22
266 516	½	⅝		10	22	22
320 409	¾	¼		12	23	27
266 509	¾	⅝		12	23	27
266 493	¾	½		8	23	27
266 455	1	⅝		16	27	34
266 486	1	½		13	28	34
266 479	1	¾		11	28	34
267 582	1¼	½		16	31	43
267 568	1¼	¾		15	31	44
266 462	1¼	1		12	31	44
267 742	1½	½		17	32	50
267 728	1½	¾		15	31	50
267 605	1½	1		12	31	50
267 704	1½	1¼		10	31	50
317 089	2	½		21	36	62
267 681	2	¾		20	36	62
267 667	2	1		18	37	61
267 643	2	1¼		15	37	61
267 629	2	1½		15	37	61
321 772	2½	1		26	45	80
321 765	2½	1¼		20	41	78
321 864	2½	1½		20	41	78
322 533	2½	2		16	41	78
321 840	3	1½		31	52	60
321 857	3	2		28	54	72
321 871	3	2½		20	50	95
321 888	4	3		23	56	13

VCR = kromirano
OK = otvor ključa

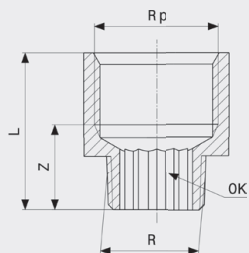

Redukcija
- bronca
Model 3242

Artikl	R	Rp	VCR	Z	L	OK
441 128	⅙	¼		14	25	6
441 135	⅙	⅝		15	26	6
322 540	¼	⅝		15	27	
322 564	⅝	½		17	32	10
322 557	⅝	¾		19	35	10
319 083	½	⅝		17	28	10
320 423	½	¾		21	37	12
320 430	½	1		19	39	
650 889	½	1¼		31	52	
441 142	¾	½		25	40	
335 311	¾	1		23	42	
441 357	¾	1¼		31	52	
650 841	¾	1½		32	53	
359 348	1	1¼		27	48	
650 858	1	1½		33	54	
650 872	1	2		34	60	
650 865	1¼	1½		33	54	

VCR = kromirano
OK = otvor ključa



Dugačka spojnica
- bronca
Model 3530

Artikl	R	L
441 456	¼	40
441 463	¼	60
441 470	¼	80
441 555	¼	100
282 400	¾	40
282 417	¾	60
282 424	¾	80
282 431	¾	100
282 448	¾	120
282 455	¾	150
282 462	¾	200
267 308	½	40
650 896	½	50
267 315	½	60
449 216	½	70
267 322	½	80
650 919	½	90
267 339	½	100
650 926	½	110
267 346	½	120
319 700	½	140
267 353	½	150
319 717	½	160
319 724	½	180
267 377	½	200
267 384	¾	40
650 933	¾	50
267 391	¾	60
650 940	¾	70
267 407	¾	80
650 957	¾	90
267 414	¾	100
650 964	¾	110
267 421	¾	120
318 413	¾	140
267 438	¾	150
318 420	¾	160
318 437	¾	180
267 445	¾	200
267 247	1	40
650 971	1	50
267 254	1	60
650 988	1	70
267 261	1	80
650 995	1	90
267 278	1	100
651 008	1	110
267 285	1	120
267 292	1	150
319 694	1	200
651 015	1¼	50
318 482	1¼	60
651 022	1¼	70
318 499	1¼	80
651 039	1¼	90
318 505	1¼	100
651 046	1¼	110
318 512	1¼	120
318 529	1¼	150
318 536	1¼	200
651 053	1½	50
319 755	1½	60
651 060	1½	70
319 762	1½	80
651 077	1½	90
319 779	1½	100
319 786	1½	120
319 748	1½	150
319 731	1½	200
651 084	2	50

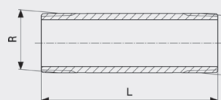

Dugačka spojnica
- bronca
Model 3530

Artikl	R	L
319 847	2	60
651 091	2	70
319 830	2	80
651 107	2	90
319 823	2	100
319 816	2	120
319 809	2	150
319 793	2	200

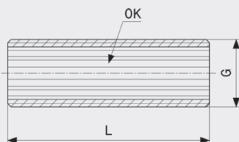

Dugačka spojnica
- bronca
Model 3535

Artikl	G	L	OK
319 670	3/8	40	10
319 267	3/8	60	10
319 335	3/8	80	10
319 281	3/8	100	10
319 687	3/8	120	10
319 274	1/2	40	12
319 366	1/2	60	12
319 359	1/2	80	12
319 342	1/2	100	12
319 656	1/2	120	12
319 328	3/4	40	17
319 298	3/4	60	17
319 304	3/4	80	17
319 311	3/4	100	17
319 663	3/4	120	17
319 250	1	40	22
319 243	1	60	22
319 236	1	80	22
319 229	1	100	22
319 649	1	120	22

OK = otvor ključa

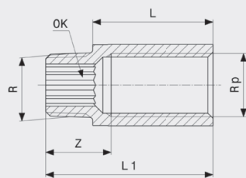

Produžetak
- bronca
Model 3525

Artikl	R	Rp	L	Rpk	Z	L1	OK
440 312 ¹	3/8	3/8	10		16	22	10
354 923	3/8	3/8	15		16	27	10
354 930	3/8	3/8	20		18	32	10
354 947	3/8	3/8	25		18	37	10
354 954	3/8	3/8	30		18	42	10
359 539	3/8	3/8	40		17	52	10
359 553	3/8	3/8	50	✓	17	62	10
364 854 ¹	1/2	1/2	12,5		19	28	12
651 121 ¹	1/2	1/2	15		19	31	12
354 961	1/2	1/2	17,5		18	33	12
354 978	1/2	1/2	20		21	36	12
354 985	1/2	1/2	25		22	41	12
354 992	1/2	1/2	30		22	46	12
355 005	1/2	1/2	40		22	56	12
355 012	1/2	1/2	50	✓	21	66	12
357 221	1/2	1/2	65	✓	21	81	12
357 238	1/2	1/2	80	✓	29	96	12
357 245	1/2	1/2	100	✓	61	116	12
440 299	1/2	1/2	120		71	136	12
440 305	1/2	1/2	150		101	166	12
440 558 ¹	3/4	3/4	12,5		21	30	17
364 861 ¹	3/4	3/4	15		20	32	17
355 029	3/4	3/4	20		21	37	17
355 036	3/4	3/4	25		26	42	17
355 043	3/4	3/4	30		23	47	17
355 050	3/4	3/4	40		23	57	17

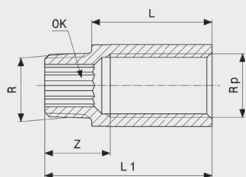

Produžetak
- bronca
Model 3525

Artikl	R	Rp	L	Rpk	Z	L1	OK
357 252	3/4	3/4	50	✓	22	67	17
357 269	3/4	3/4	65	✓	22	82	17
359 584	3/4	3/4	80	✓	37	97	17
359 577	3/4	3/4	100	✓	62	117	17
440 572 ¹⁾	1	1	15		25	35	22
440 589 ¹⁾	1	1	20		25	40	22
357 184	1	1	25		25	45	22
357 191	1	1	30		30	50	22
357 207	1	1	40		23	60	22
357 214	1	1	50		25	70	22
440 596	1	1	65		25	85	22
440 466	1	1	80		40	100	22
440 473	1	1	100		55	120	22
440 497 ¹⁾	1 1/4	1 1/4	20		27	42	27
440 503	1 1/4	1 1/4	25		27	47	27
440 510	1 1/4	1 1/4	30		27	52	27
440 527	1 1/4	1 1/4	40		41	62	27
440 534	1 1/4	1 1/4	50		51	72	27

Rpk = Rp-navoj, može se skratiti

OK = otvor ključa

¹⁾ bez DVGW ispitnog znaka

ARTIKLI OD BRONCE
NAVOJNE SPOJNICE, KAPE, PRIRUBNICE

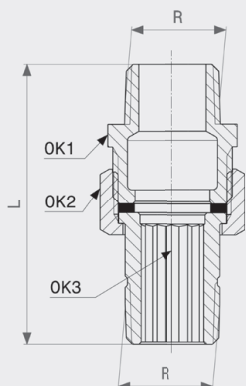

Navojna spojnica
- bronca
Model 3334

Artikl	R	L	SW1	SW2	SW3
320 188	3/8	51	27	23	
320 195	1/2	62	27	29	12
320 201	3/4	68	34	36	17
320 218	1	74	44	46	22

SW = otvor ključa

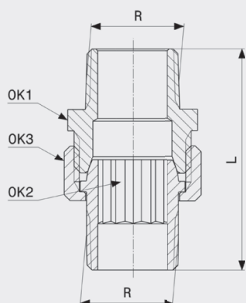

Navojna spojnica
- bronca
Model 3344

Artikl	R	L	SW1	SW2	SW3
446 871	3/8	46	22	23	8
446 888	1/2	55	27	29	12
446 895	3/4	62	34	36	17
446 901	1	69	44	46	22

SW = otvor ključa

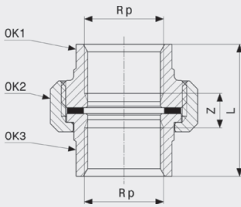

Navojna spojnica
- bronca
Model 3330

Artikl	Rp	Z	L	SW1	SW2	SW3
441 432	¼	13	35	20	29	20
282 363	⅜	12	35	20	29	21
271 022	½	11	41	25	36	25
271 039	¾	11	44	32	46	32
271 046	1	13	51	39	52	39
271 053	1¼	13	56	48	65	47
271 060	1½	15	58	53	75	55
271 077	2	13	64	66	80	66
651 138	2½	11	71	83	110	83
651 145	3	5	71	98	130	98

SW = otvor ključa

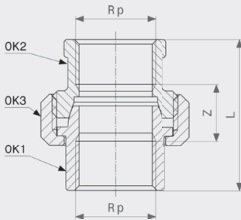

Navojna spojnica
- bronca
Model 3340

Artikl	Rp	Z	L	SW1	SW2	SW3
449 414	¼	16	38			23
446 925	⅜	17	40			29
446 932	½	17	47			36
446 949	¾	17	50			46
446 956	1	21	60	37	37	52
446 963	1¼	22	65	47	47	65
446 970	1½	25	68	55	55	75
446 987	2	23	74	66	68	80

SW = otvor ključa

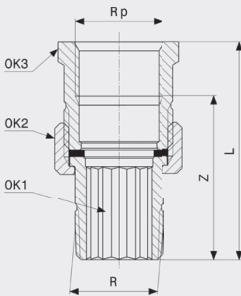

Navojna spojnica
- bronca
Model 3331

Artikl	R	Rp	Z	L	SW1	SW2	SW3
282 370	⅜	⅜	38	50	13	23	22
271 374	½	½	45	60	12	29	27
271 367	¾	¾	50	66	17	36	34
271 350	1	1	52	72	22	46	44
271 343	1¼	1¼	60	81	38	52	50
271 336	1½	1½	62	84	43	59	56
271 329	2	2	58	84	58	75	67
651 152	2½	2½	66	88	83	95	71
651 169	3	3	80	101	83	110	97

SW = otvor ključa

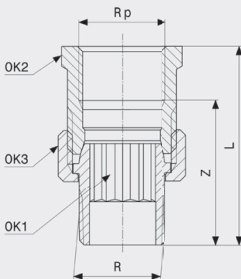

Navojna spojnica
- bronca
Model 3341

Artikl	R	Rp	Z	L	SW1	SW2	SW3
446 994	⅜	⅜	33	45	8	22	23
447 007	½	½	41	56	12	27	29
447 014	¾	¾	44	60	17	34	36
447 021	1	1	45	64	22	44	46
447 038	1¼	1¼	51	72		50	52
447 045	1½	1½	52	73		55	59
447 052	2	2	53	78		70	75

SW = otvor ključa

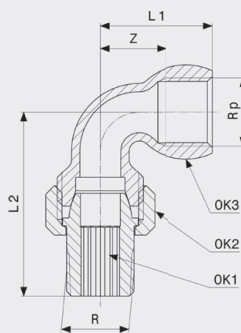

Navojna spojnica
- bronca
Model 3098

Artikl	R	Rp	Z	L1	L2	SW1	SW2	SW3
148 041	3/8	3/8	16	28	45	8	23	22
145 804	1/2	1/2	18	33	51	12	29	28

SW = otvor ključa

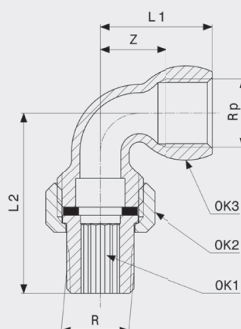

Navojna spojnica
- bronca
Model 3088

Artikl	R	Rp	Z	L1	L2	SW1	SW2	SW3
348 663	1/2	1/2	17	28	58	12	28	29
348 670	3/4	3/4	23	39	65	17	33	36
348 687	1	1	28	47	78	22	39	46
348 694	1 1/4	1 1/4	35	57	83	38	47	52
348 700	1 1/2	1 1/2	38	59	95	43	55	59
348 717	2	2	43	69	112	58	69	75

SW = otvor ključa

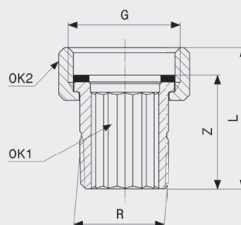

Priključna navojna spojnica
- bronca
Model 3335

Artikl	R	Z	L	SW1	SW2	G
320 225	3/8	27	32	8	23	1/2
320 232	1/2	31	39	22	29	3/4
320 249	3/4	34	42	17	36	1
320 256	1	38	46	22	46	1 1/4
319 618	1 1/4	43	52	38	52	1 1/2
319 625	1 1/2	46	56	43	59	1 3/4
319 632	2	52	62	58	75	2 3/8

SW = otvor ključa

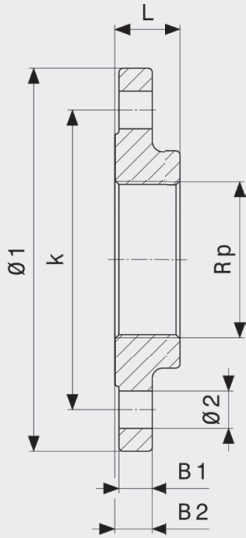

Sanpress XL-Prirubnica, PN 16
- bronca
Model 2259.2XL

Artikl	DN	Rp	Ø1	L	B1	B2	Ø2	k	n
641 603	80	3	200	34	18	20	18	160	8
641 610	100	4	220	38	18	20	18	180	8

k = Ø diobene kružnice
n = broj provrta

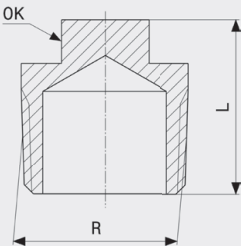

Čep
- bronca
Model 3291

Artikl	R	L	OK
441 418*	1/8	17	8
320 072	1/4	19	8
281 847	3/8	20	10
266 646	1/2	26	12
266 639	3/4	28	14
266 622	1	32	14
268 237	1 1/4	38	21
268 190	1 1/2	38	22
268 213	2	42	26
321 758	2 1/2	47	30

OK = otvor ključa

* = Isporuka samo još iz zaliha na skladištu

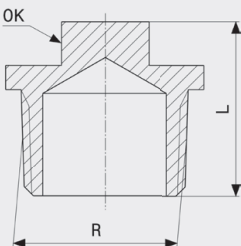

Čep
- bronca
Model 3290

Artikl	R	L	OK
441 425	1/8	17	8
320 133	1/4	20	8
320 096	3/8	20	10
320 102	1/2	24	12
320 089	3/4	26	14
320 294	1	32	14
322 175	1 1/4	38	21
322 168	1 1/2	38	32
322 151	2	42	26

OK = otvor ključa

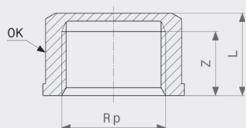

Kapa
- bronca
Model 3301

Artikl	Rp	Z	L	OK
319 151	¼	8	12	20
281 854	⅜	11	16	22
266 660	½	15	20	24
266 653	¾	16	21	30
268 367	1	19	29	38
268 305	1¼	21	30	47
268 329	1½	21	30	53
268 343	2	26	34	65

OK = otvor ključa

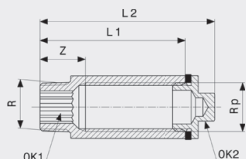

Produžetak za slavinu
- bronca
Model 3527

Artikl	R	Rp	L	Rpk	Z	L1	L2	SW1	SW2
320 263	½	½	50	✓	18	63	76	12	12

Rpk = Rp-navoj, može se skratiti
SW = otvor ključa

**ARTIKLI OD MESINGA
ČEPOVI**

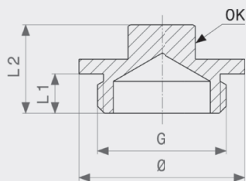

Čep
- mesing
Model 1751

Artikl	G	L1	L2	OK	Ø
106 676	⅛	6	13	9	13
102 173	¼	7	13	9	16
101 756	⅜	8	16	12	21
100 797	½	8	18	12	27
101 626	¾	8	18	14	34
102 883	1	9	18	17	41
106 584	1½	13	24	22	60

OK = otvor ključa

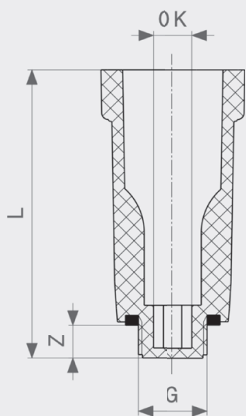

Čep za tlačnu probu
- umjetni materijal
Model 1516

Artikl	G	Z	L	OK
107 796	⅜	10	87	8
100 124	½	10	87	10
102 746	¾	13	90	14

OK = otvor ključa

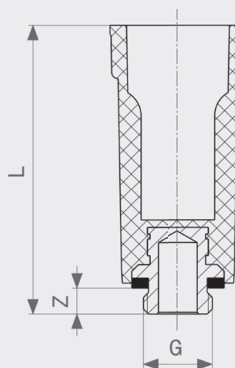

Čep za tlačnu probu

- umjetni materijal

Model 1516.113

Artikl	G	Z	L
116 644	3/8	8	85
100 766	1/2	9	87
107 666	3/4	10	87

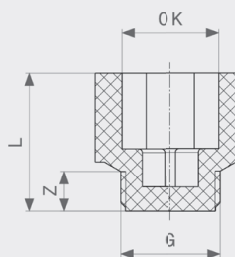

Čep za tlačnu probu

- umjetni materijal

Model 1516.512

Artikl	G	Z	L	OK
105 419	1/2	11	37	22

OK = otvor ključa

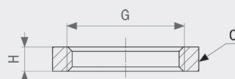

Šesterostrana matica

- mesing

Model 1911

Artikl	G	H	OK
117 290	1/8	5	19
109 264	1/4	5	22
104 696	3/8	5	25
102 241	1/2	6	28
103 347	3/4	6	33
106 195	1	6	41
113 391	1 1/4	6	51
120 115	1 1/2	6	58
128 302	2	6	70

OK = otvor ključa

**KROMIRANE SPOJNICE
LUKOVI, KOLJENA**

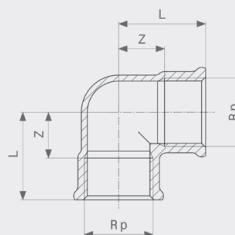

Koljeno 90°

- mesing

Model 1612

Artikl	Rp	Z	L
112 639	3/8	10	22
105 600	1/2	15	30
112 141	3/4	18	34
124 397	1	20	39

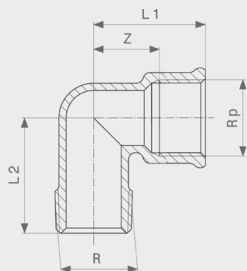

Koljeno 90°
- mesing
Model 1613

Artikl	R	Rp	Z	L1	L2
135 935	¼	¼	15	26	26
106 645	¾	¾	17	29	32
102 586	½	½	20	35	34
107 758	¾	¾	23	39	40
121 457	1	1	27	46	45

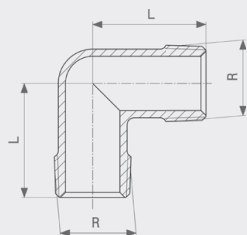

Koljeno 90°
- mesing
Model 1611

Artikl	R	L
125 059	¾	28
110 680	½	32
131 586	¾	36

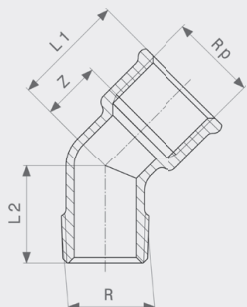

Koljeno 45°
- mesing
Model 1615

Artikl	R	Rp	Z	L1	L2
139 001	¾	¾	9	21	23
115 555	½	½	8	23	31

**KROMIRANE SPOJNICE
ZIDNE PLOČICE**

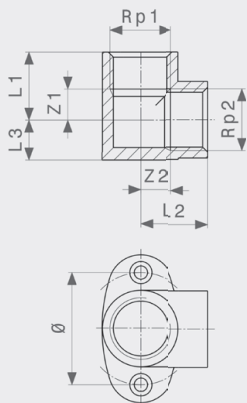

Zidna pločica
- mesing
Model 1421

Artikl	Rp1	Rp2	Z1	Z2	L1	L2	L3	Ø
109 158	½	½	8	8	20	20	14	38
113 209	½	¾	14	14	27	27	17	43
127 800	¾	¾	8	8	20	20	14	38

**KROMIRANE SPOJNICE
T-KOMADI, SPOJNICE**

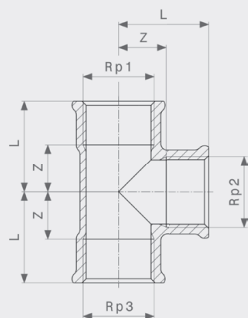

T-komad
- mesing
Model 1622

Artikl	Rp1	Rp2	Rp3	Z	L
114 275	3/8	3/8	3/8	10	22
105 525	1/2	1/2	1/2	15	30
111 762	3/4	3/4	3/4	18	34
130 190	1	1	1	20	39

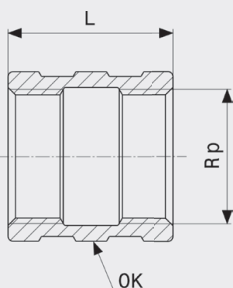

Spojnicica
- bronca
Model 3270

Artikl	Rp	VCR	L	OK
447 755	3/8	✓	23	21
447 762	1/2	✓	30	26
447 779	3/4	✓	33	32
447 786	1	✓	38	38

VCR = kromirano
OK = otvor ključa

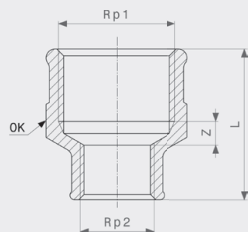

Reducir spojnicica
- bronca
Model 3240

Artikl	Rp1	Rp2	VCR	Z	L	OK
447 809*	3/8	1/4	✓			
447 816	1/2	3/8	✓	4	31	26
447 823	3/4	1/2	✓	5	32	31
447 830	1	1/2	✓	13	34	26
447 847	1	3/4	✓	7	36	38

VCR = kromirano
OK = otvor ključa
* = Isporuka samo još iz zaliha na skladištu

**KROMIRANE SPOJNICE
SPOJNICE, PRIJELAZI**

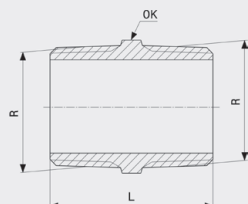

Dvostruka spojnicica
- bronca
Model 3280

Artikl	R	VCR	L	OK
447 878*	1/8	✓	18	10
447 885	1/4	✓	20	14
447 892	3/8	✓	29	18
447 908	1/2	✓	37	22
447 915	3/4	✓	40	27
447 922	1	✓	45	34

VCR = kromirano
OK = otvor ključa
* = Isporuka samo još iz zaliha na skladištu

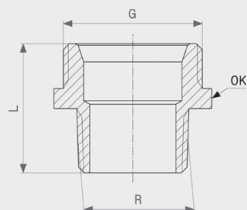

Redukcija
- bronca
Model 3246

Artikl	R	G	VCR	L	OK
448 219	3/8	1/2	✓	25	22
448 226	1/2	3/4	✓	21	27
448 233	1/2	1	✓	33	34
448 240*	3/4	1	✓	35	34
448 257	1	1 1/4	✓	39	44

VCR = kromirano

OK = otvor ključa

* = Isporuka samo još iz zaliha na skladištu

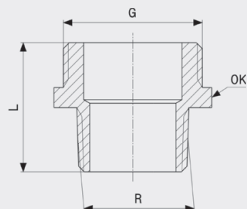

Redukcija
- bronca
Model 3247

Artikl	R	G	VCR	mlk	L	OK
458 867	1/4	3/8	✓			
458 874	3/8	1/2	✓		24	18
458 881	3/8	3/4	✓		28	27
448 189	1/2	3/4	✓		31	27
448 196	3/4	1	✓		35	34

VCR = kromirano

mlk = s unutarnjim konusom

OK = otvor ključa

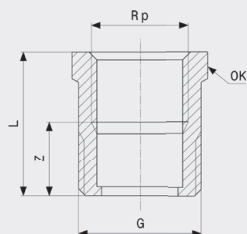

Redukcija
- bronca
Model 3244

Artikl	G	Rp	VCR	mlk	Z	L	OK
448 264	3/4	1/2	✓		14	29	27

VCR = kromirano

mlk = s unutarnjim konusom

OK = otvor ključa

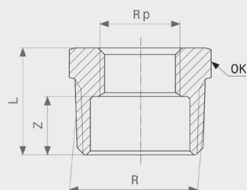

Redukcija
- bronca
Model 3241

Artikl	R	Rp	VCR	Z	L	OK
447 946	1/4	1/8	✓	10	17	14
447 953	3/8	1/8	✓	10	17	18
447 960	3/8	1/4	✓	10	17	18
447 977	1/2	1/8	✓	13	22	22
447 984	1/2	1/4	✓	13	22	22
447 991	1/2	3/8	✓	13	22	22
448 011	3/4	3/8	✓	15	23	27
448 028	3/4	1/2	✓	15	23	27
448 042	1	1/2	✓	17	28	34
448 059	1	3/4	✓	17	28	34
448 073	1 1/4	1	✓	19	31	44

VCR = kromirano

OK = otvor ključa

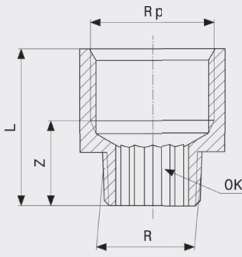

Redukcija
- bronca
Model 3242

Artikl	R	Rp	VCR	Z	L	OK
448 097	1/8	1/4	✓	14	25	6
448 103	1/8	3/8	✓	15	26	6
448 110	1/4	3/8	✓	15	27	
448 127	3/8	1/2	✓	17	32	10
448 134	3/8	3/4	✓	19	35	10
448 141	1/2	3/8	✓	17	28	10
448 158	1/2	3/4	✓	21	37	12
448 165	3/4	1/2	✓	25	40	
448 172	3/4	1	✓	23	42	

VCR = kromirano
OK = otvor ključa

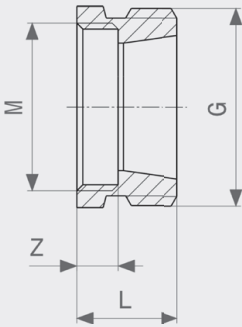

Redukcija
- bronca
Model 3251

Artikl	G	M	Z	L
448 295	3/4v	22x1i	6	14

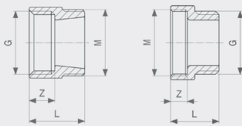

Redukcija
- bronca
Model 3252

Artikl	G	M	Z	L
448 318	1/2v	22x1i	6	18
448 332	1/2u	22x1a	9	18
448 325	3/4u	22x1a	10	20

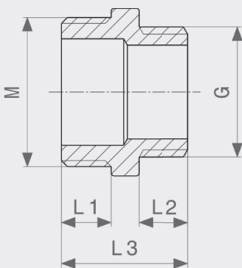

Redukcija
- bronca
Model 3253

Artikl	G	M	L1	L2	L3
448 356	1/2v	24x1a	8	8	21
448 349	3/4v	24x1a	8	9	22



Dugačka spojnica
- bronca
Model 3530

Artikl	R	L
447 465	3/8	40
447 472	3/8	60
447 489	3/8	80
447 496	3/8	100
447 526	1/2	40
447 533	1/2	60
447 540	1/2	80
447 557	1/2	100
447 564	1/2	120
447 571	1/2	150
447 588	1/2	200
447 595	3/4	40
447 601	3/4	60
447 618	3/4	80
447 625	3/4	100
447 632	3/4	120
447 649	3/4	150
447 656	3/4	200
447 663	1	40
447 687	1	80
447 694	1	100
447 700	1	120

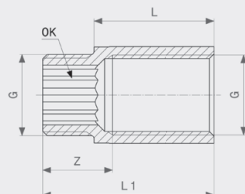

Produžetak za slavinu
- bronca
Model 3526

Artikl	G	L	Z	L1	OK
448 769	3/8	10	13	20	10
447 076 ¹	3/8	15	15	25	10
447 083 ¹	3/8	20	18	30	10
447 090 ¹	3/8	25	23	35	10
447 106 ¹	3/8	30	28	40	10
447 113 ¹	3/8	40	38	50	10
447 120 ¹	3/8	50	16	60	10
447 151 ¹	1/2	10	14	21	12
447 168 ¹	1/2	15	16	26	12
447 175 ¹	1/2	20	18	31	12
447 182 ¹	1/2	25	17	36	12
447 199 ¹	1/2	30	18	41	12
447 205 ¹	1/2	40	18	51	12
447 212 ¹	1/2	50	18	61	12
447 229 ¹	1/2	65	18	76	12
447 236 ¹	1/2	80	24	91	12
447 243 ¹	1/2	100	56	111	12
447 274 ¹	3/4	10	15	22	17
447 281 ¹	3/4	15	17	27	17
447 298 ¹	3/4	20	17	32	17
447 304 ¹	3/4	25	19	37	17
447 311 ¹	3/4	30	19	42	17
447 328 ¹	3/4	40	19	52	17
447 335 ¹	3/4	50	18	62	17
447 342 ¹	3/4	65	18	77	17
447 359 ¹	3/4	80	19	92	17
447 366 ¹	3/4	100	20	112	17
447 380	1	20	20	34	17
447 403	1	30	22	44	17

OK = otvor ključa

¹) dugi unutarnji navoj

**KROMIRANE SPOJNICE
ČEPOVI**

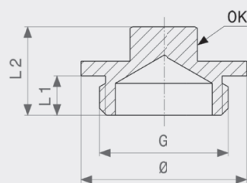

Čep
- mesing
Model 1751

Artikl	G	L1	L2	OK	Ø
155 735	1/8	6	13	9	13
137 649	1/4	7	13	9	16
108 472	3/8	8	16	12	21
105 099	1/2	8	18	12	27
113 797	3/4	8	18	14	34
124 465	1	9	18	17	41

OK = otvor ključa

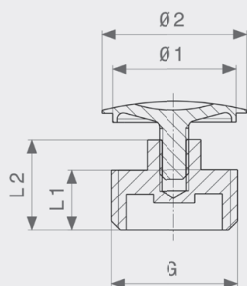

Čep
- mesing
Model 1752

Artikl	G	L1	L2	Ø1	Ø2
110 123	3/8	10	15	21	24
102 814	1/2	10	15	21	24
112 592	3/4	15	22	21	24

**KROMIRANE SPOJNICE
DVOSTRUKI PRIKLJUČNI KOMADI**

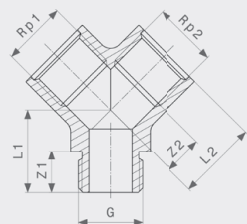

Dvostruki priključni komad
- mesing
Model 1641

Artikl	Rp1	G	Rp2	Z1	Z2	L1	L2
106 881	1/2	1/2	1/2	14	13	27	26



Šesterostrana matica
- mesing
Model 1911

Artikl	G	H	OK
140 083	1/4	5	22
108 144	3/8	5	25
108 670	1/2	6	28
117 313	3/4	6	33
139 162	1	6	41
134 945	2	6	70

OK = otvor ključa

SPOJNICA ZA CRIJEVO

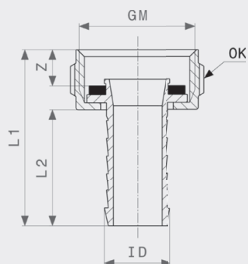

Navojna spojnica za crijevo
- mesing
Model 1811

Artikl	ID	GM	Z	L1	L2	OK
123 505	3/8	1/2	6	39	27	
105 327	1/2	3/4	8	40	26	
116 026 ¹	3/4	1	9	50	35	
142 483 ¹	1	1 1/4	9	46	29	46
109 318	3/8	1/2	6	39	27	
101 473	1/2	3/4	8	40	26	
104 276 ¹	3/4	1	9	50	35	
112 325 ¹	1	1 1/4	9	46	29	46
127 909 ¹	1 1/4	1 1/2	9	65	47	52
151 638 ¹	1 1/2	1 3/4	10	71	51	59

ID = za unutarnji promjer crijeva

GM = G-navoj matice

OK = otvor ključa

¹) višestрана matica

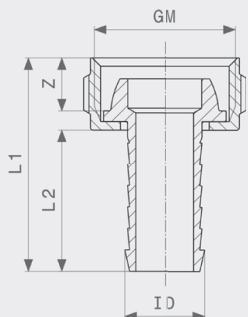

Navojna spojnica za crijevo
- mesing
Model 1812

Artikl	ID	GM	Z	L1	L2
117 696	1/2	3/4	10	40	26
129 323	3/8	1/2	9	39	27
109 073	1/2	3/4	10	40	26
111 793	3/4	1	12	52	36

ID = za unutarnji promjer crijeva

GM = G-navoj matice

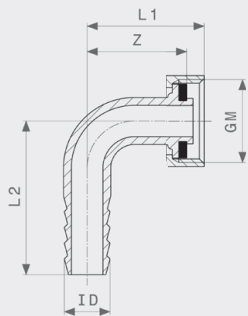

Navojna spojnica za crijevo
- mesing
Model 1813

Artikl	ID	GM	Z	L1	L2
107 949	1/2	3/4	32	38	49
126 360	3/4	1	40	47	58

ID = za unutarnji promjer crijeva

GM = G-navoj matice

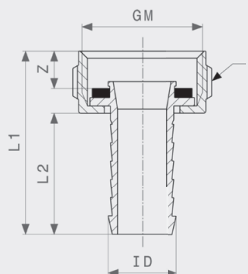

Navojna spojnica za crijevo
- mesing
Model 1814

Artikl	ID	GM	Z	L1	L2
124 779	3/8	3/4	8	42	29
124 755 ¹	1/2	1	9	44	29
113 322	3/8	3/4	8	42	29
110 642 ¹	1/2	1	9	44	29
129 798 ¹	3/4	1 1/4	9	53	36

ID = za unutarnji promjer crijeva

GM = G-navoj matice

¹) višestрана matica

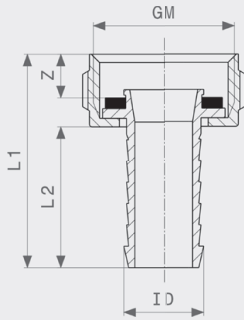

Navojna spojnica za crijevo
- mesing
Model 1817

Artikl	ID	GM	Z	L1	L2
121 723	½	½	6	41	29
131 807	¾	¾	7	51	37
111 717	½	½	6	41	29
114 008	¾	¾	7	51	37
124 694	1	1	8	52	37

ID = za unutarnji promjer crijeva
GM = G-navoj matice

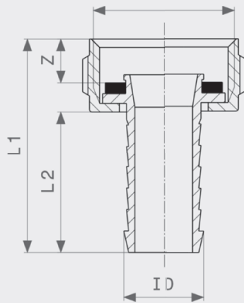

Navojna spojnica za crijevo
- mesing
Model 1819

Artikl	ID	M	Z	L1	L2
106 843	½	22x1a	3	36	28

ID = za unutarnji promjer crijeva

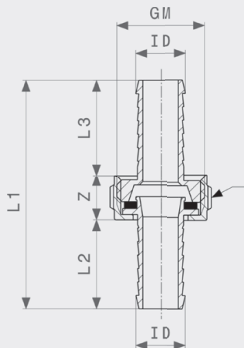

Navojna spojnica za crijevo
- mesing
Model 1821

Artikl	ID	GM	Z	L1	L2	L3
137 533	¾	½	14	71	27	30
113 384	½	¾	14	68	26	28
120 023 ¹⁾	¾	1	16	87	35	37

ID = za unutarnji promjer crijeva
GM = G-navoj matice
¹⁾ višestрана matica

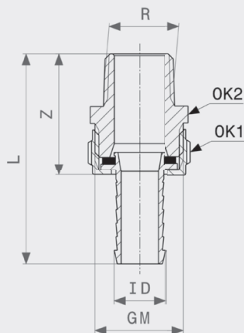

Navojna spojnica za krutu cijev
- mesing
Model 1831

Artikl	R	ID	GM	Z	L	SW1	SW2
124 878	¾	¾	½	32	59		22
105 648	½	½	¾	36	62		27
109 707 ¹⁾	¾	¾	1	42	76		34
112 318 ¹⁾	1	1	1¼	47	77	46	44
123 642 ¹⁾	1¼	1¼	1½	54	101	52	50
128 739 ¹⁾	1½	1½	1¾	57	108	55	59
138 653 ¹⁾	2	2	2¾	66	118	75	71

ID = za unutarnji promjer crijeva
GM = G-navoj matice
SW = otvor ključa
¹⁾ višestрана matica

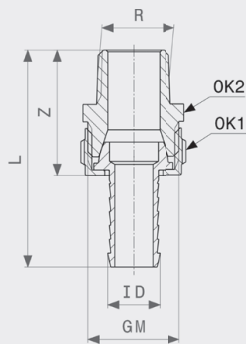

Navojna spojnica za krutu cijev

- mesing

Model 1832

Artikl	R	ID	GM	Z	L	SW1	SW2
122 416	3/8	3/8	1/2	30	57		22
104 498	1/2	1/2	3/4	36	63		27
108 816	3/4	3/4	1	41	77		34
110 734 ¹⁾	1	1	1 1/4	47	83	46	44
119 454 ¹⁾	1 1/4	1 1/4	1 1/2	53	100	52	50
125 219 ¹⁾	1 1/2	1 1/2	1 3/4	58	110	59	55
131 432 ¹⁾	2	2	2 3/8	68	120	75	71

ID = za unutarnji promjer crijeva

GM = G-navoj matice

SW = otvor klučca

¹⁾ višestрана matica

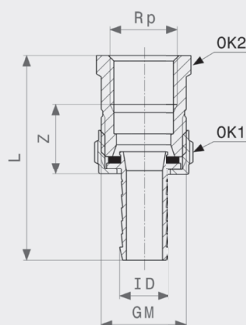

Navojna spojnica za krutu cijev

- mesing

Model 1841

Artikl	Rp	ID	GM	Z	L	SW1	SW2
145 026	3/8	3/8	1/2	18	57		22
119 690	1/2	1/2	3/4	21	63		27
126 568 ¹⁾	3/4	3/4	1	23	74		34
130 121 ¹⁾	1	1	1 1/4	23	72	46	44
150 761 ¹⁾	1 1/4	1 1/4	1 1/2	26	95	52	50

ID = za unutarnji promjer crijeva

GM = G-navoj matice

SW = otvor klučca

¹⁾ višestрана matica

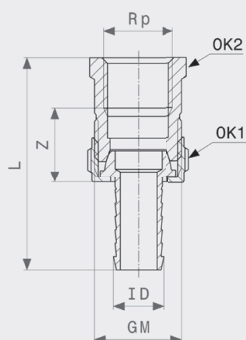

Navojna spojnica za krutu cijev

- mesing

Model 1842

Artikl	Rp	ID	GM	Z	L	SW1	SW2
145 699	3/8	3/8	1/2	17	55		22
121 013	1/2	1/2	3/4	22	64		27
125 646 ¹⁾	3/4	3/4	1	23	75		34
127 916 ¹⁾	1	1	1 1/4	23	77	46	44
151 232 ¹⁾	1 1/4	1 1/4	1 1/2	26	94	52	50
154 325 ¹⁾	1 1/2	1 1/2	1 3/4	26	98	59	55

ID = za unutarnji promjer crijeva

GM = G-navoj matice

SW = otvor klučca

¹⁾ višestрана matica

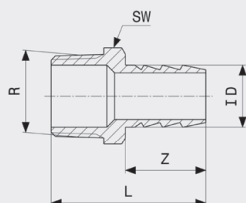

Tuljak za crijevo

- mesing

Model 1845

Artikl	R	ID	L1	L2	L3	Ø	OK
140 540	1/4	1/4	35	8	25	8	
131 067 ¹⁾	3/8	3/8	37	12	21	12	17
120 702 ¹⁾	1/2	1/2	47	16	25	14	22
137 212 ¹⁾	3/4	3/4	50	17	26	20	27
112 097	1/8	1/8	35	8	21	8	
110 598	1/4	1/4	35	8	25	8	
105 112 ¹⁾	3/8	3/8	37	12	21	12	17
101 442	1/2	1/2	47	16	25	14	22
102 548 ¹⁾	3/4	3/4	50	17	26	20	27
104 467 ¹⁾	1	1	57	20	30	27	34

ID = za unutarnji promjer crijeva

OK = otvor klučca

¹⁾ višestрана izvedba

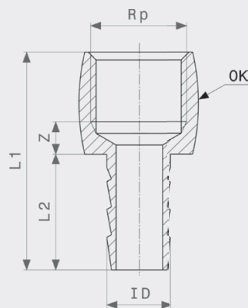

Tuljak za crijevo
- mesing
Model 1846

Artikl	Rp	ID	Z	L1	L2	OK
125 431	1/4	1/4	4	40	25	
135 393 ¹⁾	3/8	3/8	6	39	21	20
136 185 ¹⁾	1/2	1/2	7	47	25	24
145 781 ¹⁾	3/4	3/4	8	50	26	30
129 606	1/8	1/8	3	36	25	
130 084	1/4	1/4	4	40	25	
112 479 ¹⁾	3/8	3/8	6	39	21	20
105 679	1/2	1/2	7	47	25	24
111 106 ¹⁾	3/4	3/4	8	50	26	30
118 105 ¹⁾	1	1	8	58	30	37

ID = za unutarnji promjer crijeva
OK = otvor ključa
¹⁾ višestrana izvedba

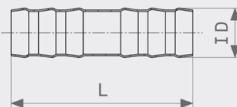

Spojnicica za crijevo
- mesing
Model 1851

Artikl	ID	L
109 875	1/2	50
108 168	3/4	50
124 298	1	60

ID = za unutarnji promjer crijeva

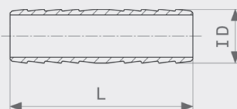

Spojnicica za crijevo
- mesing
Model 1852

Artikl	ID	L
124 007	3/8	52
110 925	1/2	48
108 632	3/4	55
130 701	1	62

ID = za unutarnji promjer crijeva

proiz. broj	strana	proiz. broj	strana	proiz. broj	strana	proiz. broj	strana	proiz. broj	strana
100 124	17	116 026	25	264 109	4	267 742	10	318 017	6
100 766	18	116 644	18	264 123	4	267 766	7	318 024	6
100 797	17	117 290	18	264 147	4	267 780	7	318 031	7
101 442	27	117 313	24	264 161	5	268 190	16	318 048	4
101 473	25	117 696	25	264 185	5	268 213	16	318 413	11
101 626	17	118 105	28	264 208	5	268 237	16	318 420	11
101 756	17	119 454	27	264 222	6	268 305	17	318 437	11
102 173	17	119 690	27	264 246	6	268 329	17	318 482	11
102 241	18	120 023	26	264 260	6	268 343	17	318 499	11
102 548	27	120 115	18	264 284	6	268 367	17	318 505	11
102 586	19	120 702	27	264 307	6	268 862	7	318 512	11
102 746	17	121 013	27	264 321	6	268 879	7	318 529	11
102 814	24	121 457	19	264 420	6	269 098	8	318 536	11
102 883	17	121 723	26	264 444	6	269 111	8	319 076	10
103 347	18	122 416	27	264 468	6	269 135	8	319 083	10
104 276	25	123 505	25	266 356	7	269 159	8	319 113	8
104 467	27	123 642	26	266 363	7	269 173	8	319 137	7
104 498	27	124 007	28	266 370	7	269 197	4	319 151	17
104 696	18	124 298	28	266 394	7	269 210	4	319 229	12
105 099	24	124 397	18	266 417	7	269 234	4	319 236	12
105 112	27	124 465	24	266 431	7	269 258	4	319 243	12
105 327	25	124 694	26	266 455	10	269 272	4	319 250	12
105 419	18	124 755	25	266 462	10	269 296	4	319 267	12
105 525	20	124 779	25	266 479	10	271 022	14	319 274	12
105 600	18	124 878	26	266 486	10	271 039	14	319 281	12
105 648	26	125 059	19	266 493	10	271 046	14	319 298	12
105 679	28	125 219	27	266 509	10	271 053	14	319 304	12
106 195	18	125 431	28	266 516	10	271 060	14	319 311	12
106 584	17	125 646	27	266 523	8	271 077	14	319 328	12
106 645	19	126 360	25	266 530	8	271 329	14	319 335	12
106 676	17	126 568	27	266 547	8	271 336	14	319 342	12
106 843	26	127 800	19	266 554	7	271 343	14	319 359	12
106 881	24	127 909	25	266 561	7	271 350	14	319 366	12
107 666	18	127 916	27	266 578	7	271 367	14	319 526	8
107 758	19	128 302	18	266 585	7	271 374	14	319 618	15
107 796	17	128 739	26	266 592	8	271 855	7	319 625	15
107 949	25	129 323	25	266 608	8	271 879	7	319 632	15
108 144	24	129 606	28	266 615	8	271 893	7	319 649	12
108 168	28	129 798	25	266 622	16	271 916	7	319 656	12
108 472	24	130 084	28	266 639	16	271 930	7	319 663	12
108 632	28	130 121	27	266 646	16	281 717	4	319 670	12
108 670	24	130 190	20	266 653	17	281 748	4	319 687	12
108 816	27	130 701	28	266 660	17	281 755	5	319 694	11
109 073	25	131 067	27	267 247	11	281 809	6	319 700	11
109 158	19	131 432	27	267 254	11	281 823	10	319 717	11
109 264	18	131 586	19	267 261	11	281 847	16	319 724	11
109 318	25	131 807	26	267 278	11	281 854	17	319 731	11
109 707	26	134 945	24	267 285	11	282 103	7	319 748	11
109 875	28	135 393	28	267 292	11	282 127	8	319 755	11
110 123	24	135 935	19	267 308	11	282 349	7	319 762	11
110 598	27	136 185	28	267 315	11	282 356	8	319 779	11
110 642	25	137 212	27	267 322	11	282 363	14	319 786	11
110 680	19	137 533	26	267 339	11	282 370	14	319 793	12
110 734	27	137 649	24	267 346	11	282 400	11	319 809	12
110 925	28	138 653	26	267 353	11	282 417	11	319 816	12
111 106	28	139 001	19	267 377	11	282 424	11	319 823	12
111 717	26	139 162	24	267 384	11	282 431	11	319 830	12
111 762	20	140 083	24	267 391	11	282 448	11	319 847	12
111 793	25	140 540	27	267 407	11	282 455	11	320 072	16
112 097	27	142 483	25	267 414	11	282 462	11	320 089	16
112 141	18	145 026	27	267 421	11	294 571	5	320 096	16
112 318	26	145 699	27	267 438	11	294 595	5	320 102	16
112 325	25	145 781	28	267 445	11	294 618	5	320 119	8
112 479	28	145 804	15	267 520	7	294 632	5	320 133	16
112 592	24	148 041	15	267 544	7	294 656	5	320 188	13
112 639	18	150 761	27	267 568	10	296 643	5	320 195	13
113 209	19	151 232	27	267 582	10	296 667	5	320 201	13
113 322	25	151 638	25	267 605	10	317 089	10	320 218	13
113 384	26	154 325	27	267 629	10	317 959	4	320 225	15
113 391	18	155 735	24	267 643	10	317 966	4	320 232	15
113 797	24	259 778	5	267 667	10	317 973	4	320 249	15
114 008	26	264 000	4	267 681	10	317 980	4	320 256	15
114 275	20	264 024	4	267 704	10	317 997	4	320 263	17
115 555	19	264 048	4	267 728	10	318 000	4	320 270	8

proiz. broj	strana	proiz. broj	strana	proiz. broj	strana	proiz. broj	strana	proiz. broj	strana
320 287	8	357 252	13	446 901	13	447 878	20	650 858	10
320 294	16	357 269	13	446 925	14	447 885	20	650 865	10
320 409	10	359 348	10	446 932	14	447 892	20	650 872	10
320 416	8	359 539	12	446 949	14	447 908	20	650 889	10
320 423	10	359 553	12	446 956	14	447 915	20	650 896	11
320 430	10	359 577	13	446 963	14	447 922	20	650 919	11
320 614	6	359 584	13	446 970	14	447 946	21	650 926	11
320 621	6	362 492	6	446 987	14	447 953	21	650 933	11
320 638	6	362 508	6	446 994	14	447 960	21	650 940	11
320 645	4	362 515	6	447 007	14	447 977	21	650 957	11
320 652	4	362 522	6	447 014	14	447 984	21	650 964	11
320 669	4	364 854	12	447 021	14	447 991	21	650 971	11
320 676	4	364 861	12	447 038	14	448 011	21	650 988	11
320 683	4	440 299	12	447 045	14	448 028	21	650 995	11
320 690	4	440 305	12	447 052	14	448 042	21	651 008	11
321 680	8	440 312	12	447 076	23	448 059	21	651 015	11
321 697	8	440 466	13	447 083	23	448 073	21	651 022	11
321 710	4	440 473	13	447 090	23	448 097	22	651 039	11
321 727	6	440 497	13	447 106	23	448 103	22	651 046	11
321 734	6	440 503	13	447 113	23	448 110	22	651 053	11
321 741	8	440 510	13	447 120	23	448 127	22	651 060	11
321 758	16	440 527	13	447 151	23	448 134	22	651 077	11
321 765	10	440 534	13	447 168	23	448 141	22	651 084	11
321 772	10	440 558	12	447 175	23	448 158	22	651 091	12
321 789	8	440 572	13	447 182	23	448 165	22	651 107	12
321 796	4	440 589	13	447 199	23	448 172	22	651 121	12
321 840	10	440 596	13	447 205	23	448 189	21	651 138	14
321 857	10	441 074	4	447 212	23	448 196	21	651 145	14
321 864	10	441 081	6	447 229	23	448 219	21	651 152	14
321 871	10	441 098	10	447 236	23	448 226	21	651 169	14
321 888	10	441 104	10	447 243	23	448 233	21		
322 076	7	441 111	10	447 274	23	448 240	21		
322 083	7	441 128	10	447 281	23	448 257	21		
322 090	7	441 135	10	447 298	23	448 264	21		
322 106	7	441 142	10	447 304	23	448 271	5		
322 113	7	441 357	10	447 311	23	448 288	5		
322 120	7	441 364	8	447 328	23	448 295	22		
322 137	7	441 371	8	447 335	23	448 318	22		
322 144	7	441 388	8	447 342	23	448 325	22		
322 151	16	441 395	7	447 359	23	448 332	22		
322 168	16	441 401	8	447 366	23	448 349	22		
322 175	16	441 418	16	447 380	23	448 356	22		
322 533	10	441 425	16	447 403	23	448 769	23		
322 540	10	441 432	14	447 465	23	449 216	11		
322 557	10	441 449	5	447 472	23	449 315	9		
322 564	10	441 456	11	447 489	23	449 339	8		
335 311	10	441 463	11	447 496	23	449 346	8		
348 663	15	441 470	11	447 526	23	449 414	14		
348 670	15	441 487	9	447 533	23	458 775	9		
348 687	15	441 494	9	447 540	23	458 782	9		
348 694	15	441 517	8	447 557	23	458 799	9		
348 700	15	441 524	8	447 564	23	458 805	9		
348 717	15	441 531	8	447 571	23	458 812	9		
354 923	12	441 555	11	447 588	23	458 829	9		
354 930	12	443 177	8	447 595	23	458 836	9		
354 947	12	446 666	9	447 601	23	458 843	9		
354 954	12	446 673	9	447 618	23	458 850	9		
354 961	12	446 680	9	447 625	23	458 867	21		
354 978	12	446 697	9	447 632	23	458 874	21		
354 985	12	446 734	9	447 649	23	458 881	21		
354 992	12	446 741	9	447 656	23	641 603	16		
355 005	12	446 758	9	447 663	23	641 610	16		
355 012	12	446 765	8	447 687	23	650 698	4		
355 029	12	446 772	8	447 694	23	650 704	4		
355 036	12	446 789	8	447 700	23	650 711	5		
355 043	12	446 796	8	447 755	20	650 728	4		
355 050	12	446 802	8	447 762	20	650 735	6		
357 184	13	446 833	9	447 779	20	650 742	6		
357 191	13	446 840	9	447 786	20	650 759	6		
357 207	13	446 857	9	447 809	20	650 766	6		
357 214	13	446 864	9	447 816	20	650 773	6		
357 221	12	446 871	13	447 823	20	650 780	7		
357 238	12	446 888	13	447 830	20	650 803	8		
357 245	12	446 895	13	447 847	20	650 841	10		

model	strana	model	strana	model	strana	model	strana	model	strana
1421	19	3471	5						
1516	17	3525	12						
1516.113	18	3525	13						
1516.512	18	3526	23						
1611	19	3527	17						
1612	18	3530	11						
1613	19	3530	12						
1615	19	3530	23						
1622	20	3531	7						
1641	24	3535	12						
1751	17								
1751	24								
1752	24								
1811	25								
1812	25								
1813	25								
1814	25								
1817	26								
1819	26								
1821	26								
1831	26								
1832	27								
1841	27								
1842	27								
1845	27								
1846	28								
1851	28								
1852	28								
1911	18								
1911	24								
2259.2XL	16								
3001	5								
3003	5								
3004	5								
3088	15								
3090	4								
3091	4								
3092	4								
3098	15								
3120	4								
3121	5								
3130	6								
3180	6								
3240	7								
3240	20								
3241	10								
3241	21								
3242	10								
3242	22								
3243	9								
3244	9								
3244	21								
3245	8								
3246	8								
3246	21								
3247	9								
3247	21								
3251	22								
3252	22								
3253	22								
3270	7								
3270	20								
3280	8								
3280	20								
3290	16								
3291	16								
3301	17								
3330	14								
3331	14								
3334	13								
3335	15								
3340	14								
3341	14								
3344	13								