

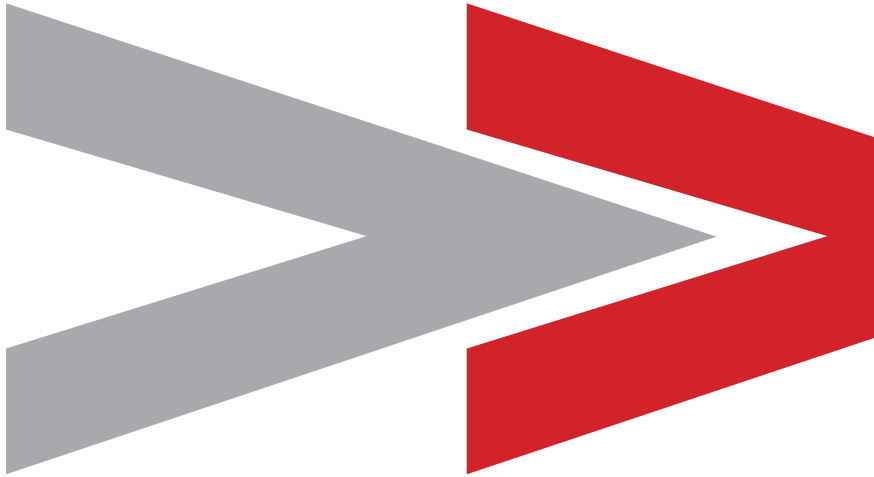

www.sistemair.com

Central Vacuum Systems



PRODUCT RANGE



Expertise & innovation

Sistem Air central vacuum systems

Improve the quality
of the air in your house,
improve the quality of your life

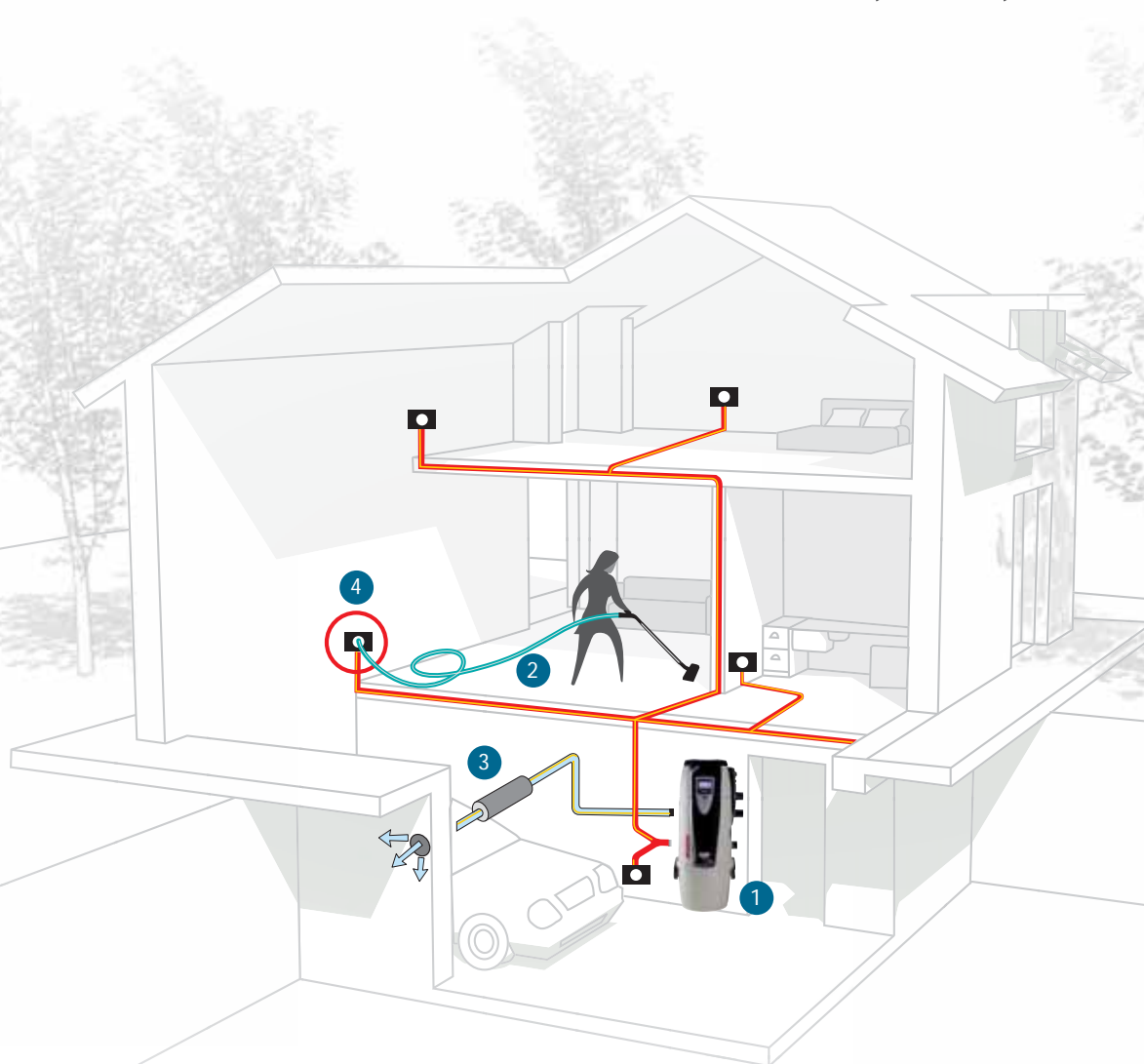

Sistem Air, a brand that means a guarantee:



Sistem Air Group is a company that has expanded on an international basis, with eight branch offices in Europe and that operates on the market of 30 countries in the world.

With the aim of spreading the culture of the central vacuum system, Sistem Air group works with a dynamic and structured network, able to adapt to the most different requirements, in terms of management and technological solutions.

Research and **development** have always been the priority, granting this way a range of products with highly innovative features in every detail. The new range by Sistem Air is the result of a sum of choices finalized to obtain the maximum quality, together with a continuing technological evolution, in order to supply the right solution for every installation need.



100% made in ITALY



Our WAY...

All Sistem Air products are the result of an extremely accurate engineering, production experience, clever consulting approach during installation and after sales service: only in this way we can offer the best in every application field.

Our new product range



TECNO R-evolution

Page 6 **Domestic**

DOMESTIC/RESIDENTIAL APPLICATIONS

- 1 OPERATOR
- MAX. 450 M²



Page 12 **Generation**

DOMESTIC/RESIDENTIAL APPLICATIONS

- 1 OPERATOR
- MAX. 450 M²



Page 16 **willy**

VERTICAL BUILDING/RESIDENTIAL APPLICATIONS-BUILT-IN INSTALLATION

- 1 OPERATOR
- MAX 300 M²



Page 20



DOMESTIC/RESIDENTIAL APPLICATIONS-INSTALLATION IN EXISTING HOUSES

- 1 OPERATOR
- MAX. 60 M² EACH



Page 24



DOMESTIC/RESIDENTIAL APPLICATIONS

- 1 OPERATOR
- MAX.120 M²



TECNO Star

Page 30 **★ ★ Dual Power**

DOMESTIC/RESIDENTIAL APPLICATIONS

- 2 OPERATORS
- MAX. 450 M²

our PASSION!



Page 36 **FEYO BLOCH**
professional
PROFESSIONAL APPLICATIONS
- 3 OPERATORS
- MAX 1800 M²



Page 40 **Industrial Clean**
big/small
INDUSTRIAL APPLICATIONS
- 8 OPERATORS FOR EACH SEPARATOR



Page 41 **Industrial Motor**
INDUSTRIAL APPLICATIONS
- NO LIMITS WITH OUR MODULAR SYSTEM



Page 46 **Autocleaner**
universal system
UNIVERSAL SELF-CLEANING SYSTEM



Page 50
FITTINGS/INSTALLATION KITS



Page 58
OUR ACCESSORIES



Page 59
OUR SUCTION INLETS



The evolution goes on



TECNO R-evolution Domestic

Four models for surfaces  up to 450 m²

Tecno R-evolution: a technological heart with **10 new features for 10 advantages**



ENERGY SAVING

A reduction of the energy consumption, with the same efficiency, on the two best sold models.



BIVAC: CHOOSE THE FILTRATION YOU PREFER

TECNO R-evolution is the only central vacuum unit in the world that allows to choose between cyclonic filtering (you don't need the bag) and bag filtration (you don't need to clean the filter).



YOU CAN FORGET ABOUT CLEANING THE FILTER

Dust doesn't adhere to the filter, because the conic shape makes the dust fall into the bucket, while the aluminate material of the filter allows the loss of static charges through a dedicated ground connection.

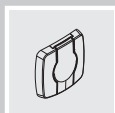

THE COMFORT OF THE INTEGRATED INLET

It is useful for cleaning surfaces and objects near the central vacuum unit (available with cyclonic filtering).

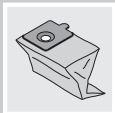

THE FILTERING BAG IN MICROFIBER

It allows a high filtering degree: strong and capacious, it assures the real hygiene during disposal, thanks to the closing flap of the bag.

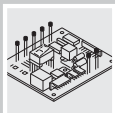

THE SMART MANAGEMENT SOFTWARE (CUSTOMIZABLE)

The TECNO R-evolution central vacuum unit supplies security control tools, set by Sistem Air, that can be customized by the user, in order to simplify maintenance. Without the need of further connections.

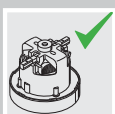

THE SAFETY OF THE VACUUM BREAKER VALVE

Thanks to the vacuum breaker valve and to the Soft Start system, safety is guaranteed, because they don't let the motor work in critical conditions.



A TRUTHFUL MAINTENANCE SYSTEM

Special control sensors convey the real conditions of the central unit to a microprocessor, that points out anomalies through a display, in order to re-establish the correct working of the unit.



THE NEW DISPLAY: EASY TO USE

The conditions of the central vacuum unit are always under control, thanks to the clear messages of the new display.



AN ELEGANT DESIGN

Its refined design makes the TECNO R-evolution vacuum unit a design objet.



BiVac system: choose the central unit you prefer

Choose the filtration you prefer, with the BiVac (Sistem Air exclusive)



The new TECNO R-evolution central units can be installed with the filtration system chosen by the user:



- **with cyclonic filtration**, the dust bag is optional and it's possible to use an inlet integrated in the central unit;



- **with microfiber bag filtration**, the filter maintenance is not necessary (because the dust is conveyed in the bag).

Low maintenance filtering system (Sistem Air exclusive)

The innovative filtering system of the TECNO R-evolution vacuum units consists in a conic filter, made in polyester and aluminum fibre, washable and certified class M, connected to the earthing of the unit. For this reason this filter assures the loss of static charges, allowing the dust to fall into the bucket, thanks also to its conic shape.

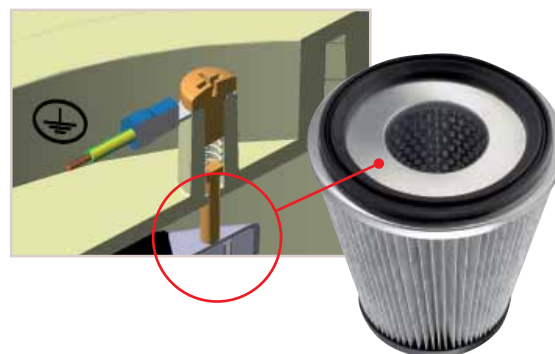

Selection table



1 operator

The TECNO R-evolution central units are used for domestic installations with surfaces up to 450 m². The central vacuum unit should be selected according to the surface area to be cleaned, in order to ensure long life and best performances over time.

Overall surface area	MODEL	ARTICLE	Maximum inlet number	Dust container/ bag capacity l	Maintenance computer	Filtering surface cm ²	Power supply Vac	Motor power kW	Maximum air flow m ³ /h
Max 150 m ²	T. Revolution 150	3110.2T	4	21/18	YES	6700	220/240	1,1	200
Max 250 m ²	T. Revolution 250	3112.2T	7	21/18	YES	6700	220/240	1,3	234
Max 350 m ²	T. Revolution 350	3113.2T	11	21/18	YES	6700	220/240	1,9	309
Max 450 m ²	T. Revolution 450	3115.2T	16	21/18	YES	6700	220/240	2,1	320

TRASFORMATION BiVac

Content of the transformation kit:

- service inlet
- BiVac dust inlet, which is to be fixed to the hole
- plug to close the standard dust inlet
- gasket to hold the BiVac bag, which will substitute the cyclonic separator
- microfiber dust bag to be fitted on the BiVac inlet connection

The central vacuum unit is to be installed after having chosen one of the proposed installations

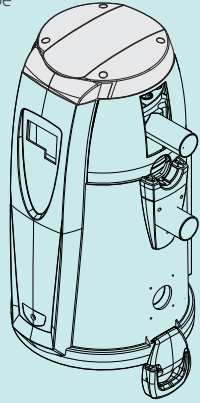

A INSTALLATION WITH CYCLONIC FILTRATION

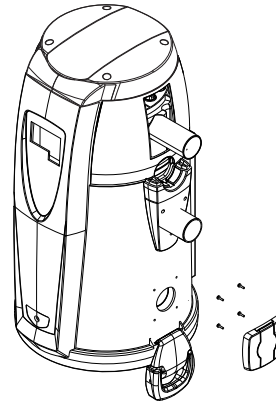

A1 Fix the inlet with the screws provided.

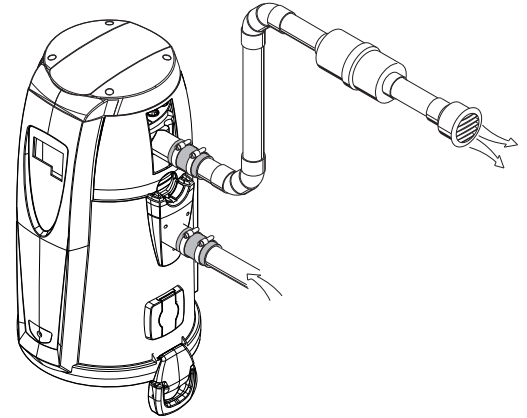

A2 Connect the central vacuum cleaner to the piping system through the standard connections foreseen by the constructor.

B INSTALLATION WITH BAG FILTRATION

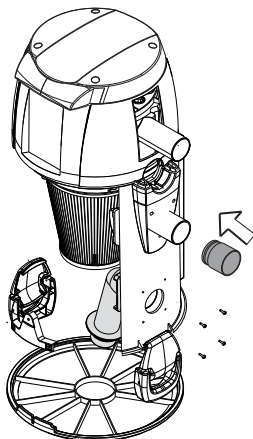

B1 Fix the connection provided in the hole and close the standard dust inlet.

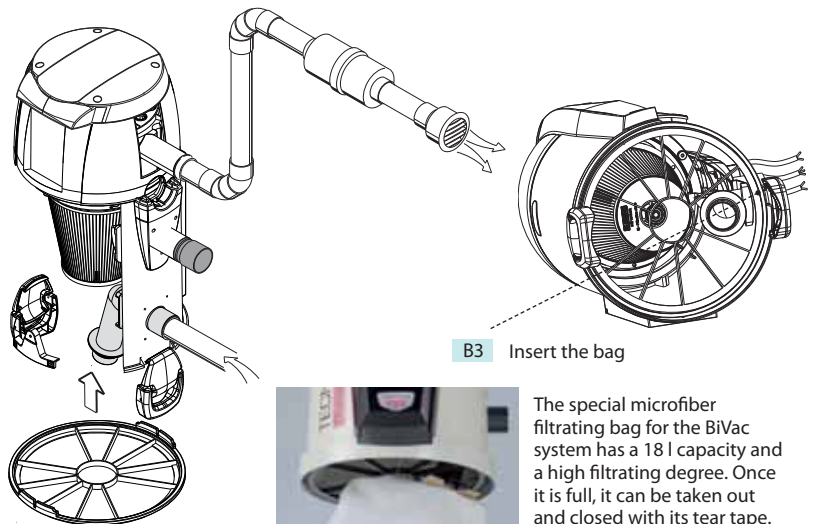

B2 Insert the grid. In this kind of installation the connection to the inlet pipe is to be done through the additional connection provided.

B3 Insert the bag



The special microfiber filtering bag for the BiVac system has a 18 l capacity and a high filtering degree. Once it is full, it can be taken out and closed with its tear tape.



Why ENERGY SAVING is important

The whole range of new products by Sistem Air has been realized keeping in mind the reduction of the environmental impact, both during production and use. In particular, on the TECNO R-evolution line we assure a reduction of energy consumption of 15% and 7% on the two best sold models, with the same efficiency.





TECHNICAL FEATURES

The central vacuum cleaners of the Tecno R-evolution series are made of plastic materials, polypropylene and ABS so that they can resist against atmospheric agents. They are designed and realized in conformity with all regulations in force and European directives but also take great care of functionality, power and capacity.

Additional features:

- possible connection of the pipes from the left or from the right;
- programmable computer for maintenance cycles with dedicated software which can show that the dust container must be emptied, the filter cartridge must be cleaned and the motor needs maintenance;
- soundproof motor compartment;
- electric single phase motors with brushes and direct cooling;
- safety temperature sensor which protects the motor with automatic stop and start in case of problems.

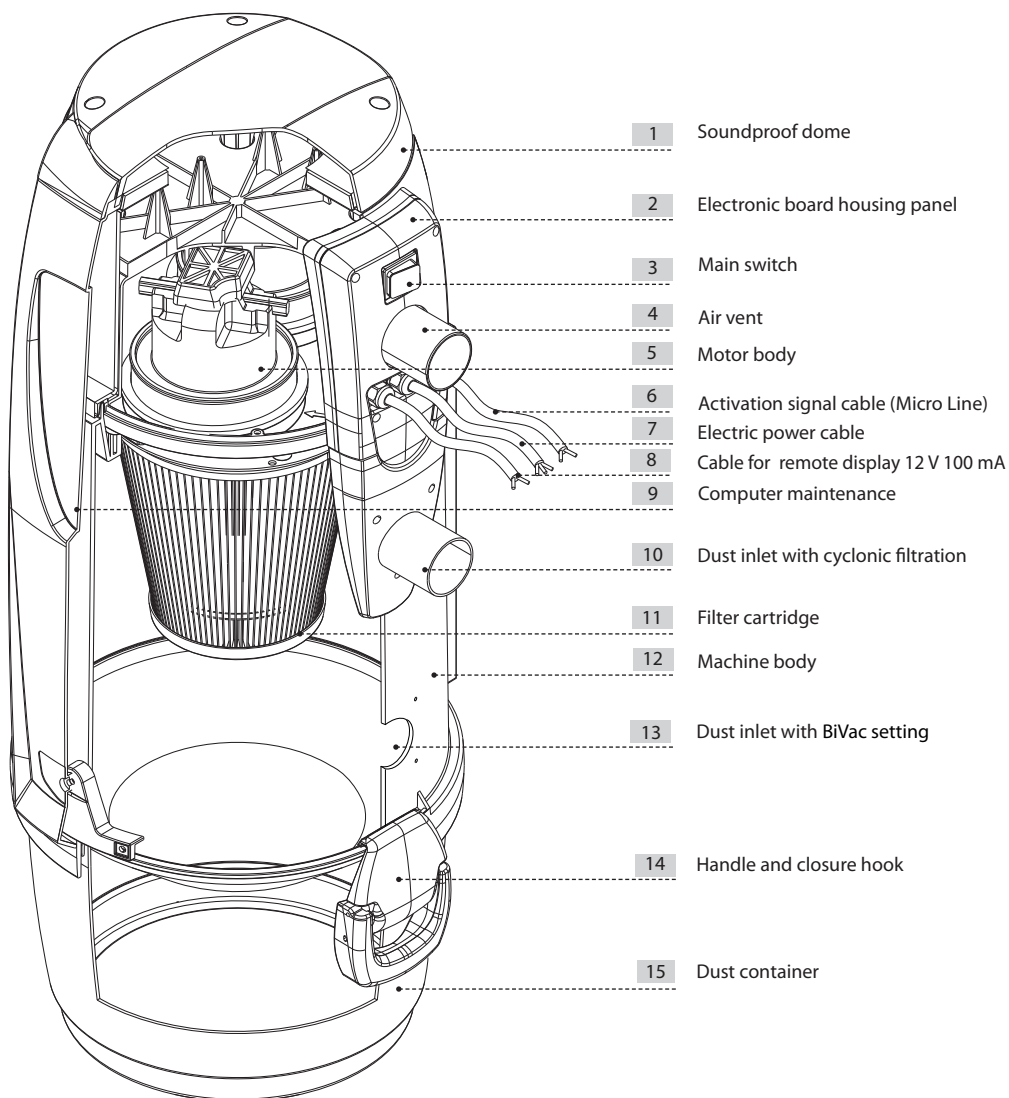

Measurements and technical details

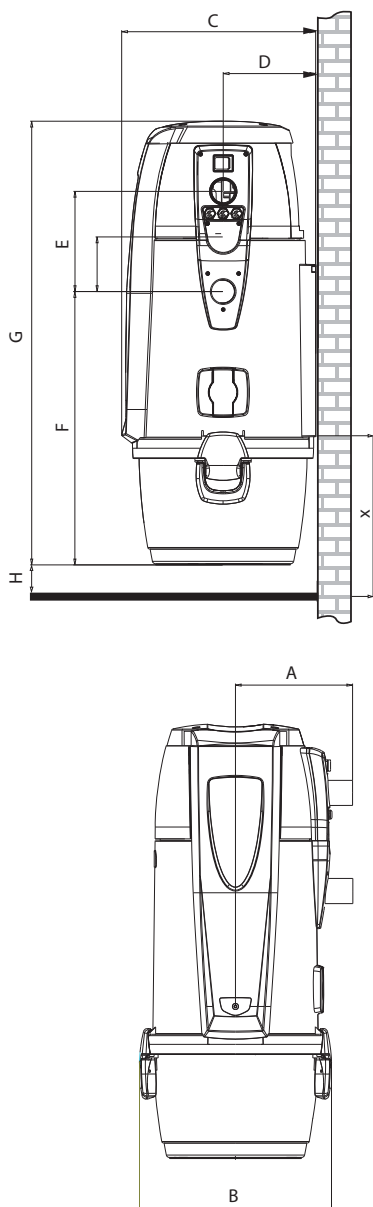

Model Article		TECNO R-evolution			
		Tecno R-evolution 150	Tecno R-evolution 250	Tecno R-evolution 350	Tecno R-evolution 450
		3110.2T	3112.2T	3113.2T	3115.2T
Computer maintenance		YES	YES	YES	YES
Dust inlet pipe	Ø mm	50	50	50	50
Insulation level	IP	44	44	44	44
Power	Volt ac	220/240	220/240	220/240	220/240
Frequency	Hz	50/60	50/60	50/60	50/60
Motor power	kW	1,1	1,3	1,9	2,1
Absorption	A	5,0	5,6	8,2	9,5
Socket supply	Volt dc	12	12	12	12
Maximum air flow	m³/h	200	234	309	320
Filtering surface area	cm²	6700	6700	6700	6700
Dust container capacity	l	21	21	21	21
BiVac bag capacity	l	18	18	18	18
Air vent		YES	YES	YES	YES
Air discharge silencer		YES	YES	YES	YES
Weight	kg	8,5	17	19	19
Measurement A	mm	230	230	230	230
Measurement B	mm	370	370	370	370
Measurement C	mm	380	380	380	380
Measurement D	mm	185	185	185	185
Measurement E	mm	108	108	195	195
Measurement F	mm	585	585	585	585
Measurement G	mm	915	915	915	915
Measurement H	mm	100	100	100	100
Measurement X	mm	500	500	500	500
Noise level lower than	dB(A)	70			



Detail of the bag filtering setting



Vacuum breaker valve



Integrated inlet



View of the keyboard





Linea TECNO
Evolution 

Five models for surfaces  up to 450 m²



It is possible to connect the piping both from the left or the right side.

IP44 protection index enables TECNO EVOLUTION GENERATION units to be installed outside when needed; also using Sistem CASE boxes.

Selection table



1 operator

The central units can be used by a single operator. The central vacuum units should be selected according to the surface area to be cleaned, in order to ensure long life and best performance over time. Once the size of the surface area has been established, one can start applying certain selection criteria, such as the capacity of the dust container, the filtering surface and the size of the central unit.

It is possible to add a remote control panel to manage the maintenance cycles of the central vacuum unit.



Example of remote control panel

Overall surface area	MODEL	ARTICLE	Maximum inlet number	Operators maximum	Maintenance computer	Dust container/ bag capacity l	Filtering surface cm ²	Power supply V _{ac}	Motor power kW	Maximum air flow m ³ /h
Max 150 m ²	MINI TE	3107.1TE	4	1	NO	15	3100	220/240	1,3	234
	SA 050/TE	3110.1TE	4	1	NO	21	6700	220/240	1,3	234
Max 250 m ²	SA 100 TE	3112.1TE	7	1	NO	21	6700	220/240	1,4	184
Max 350 m ²	SA 200 TE	3113.1TE	11	1	NO	21	6700	220/240	1,9	309
Max 450 m ²	SA 400 TE	3115.1TE	16	1	NO	21	6700	220/240	2,1	309





TECHNICAL FEATURES

The central vacuum cleaners of the Generation series are made of plastic materials, polypropylene and ABS so that they can resist against atmospheric agents. They are designed and realized in conformity with all regulations in force and European directives but also take great care of functionality, power and capacity.

Additional features:

- possible connection of the pipes from the left or from the right;
- Soft Start system to reduce the consumption of the motor during the start up phase;
- filter cartridge in filter class L, in polyester, washable;
- vacuum breaker valve to protect the motor;
- single phase motors with brushes and direct cooling;
- safety temperature sensor which protects the motor with automatic stop and start in case of problems.

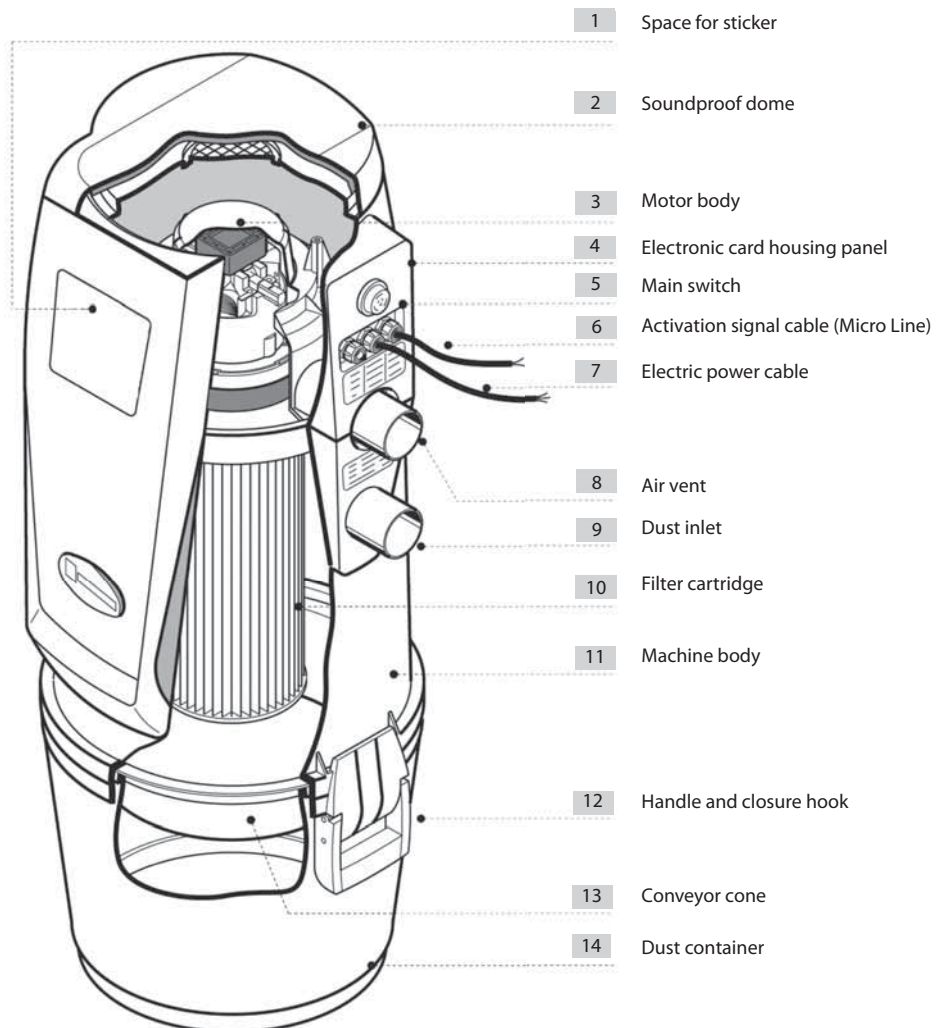

MEASUREMENTS AND TECHNICAL DETAILS

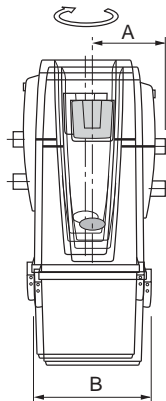
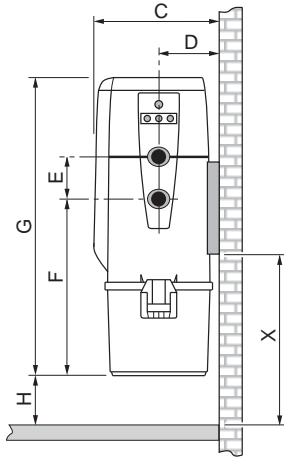

		TECNO Evolution Generation				
Model Articolo		MINI TE	SA 050 TE	SA 100 TE	SA 200 TE	SA 400 TE
		3107.1TE	3110.1TE	3112.1TE	3113.1TE	3115.1TE
Computer maintenance		NO	NO	NO	NO	NO
Dust inlet pipe	∅ mm	50	50	50	50	50
Insulation level	IP	44	44	44	44	44
Power		220/240	220/240	220/240	220/240	220/240
Frequency	Hz	50/60	50/60	50/60	50/60	50/60
Motor power	kW	1,3	1,3	1,4	1,9	2,1
Absorption	A	5,6	5,6	6,5	8,2	9,5
Socket supply	Volt dc	12	12	12	12	12
Maximum air flow	m ³ /h	234	234	184	309	320
Filtering surface areas	cm ²	3100	6700	6700	6700	6700
Dust container capacity	l	15	21	21	21	21
Air vent		YES	YES	YES	YES	YES
Air discharge silencer		YES	YES	YES	YES	YES
Weight	kg	8,5	17	17	19	19
Measurement A	mm	210	230	230	230	230
Measurement B	mm	325	370	370	370	370
Measurement C	mm	345	380	380	380	380
Measurement D	mm	168	185	185	185	185
Measurement E	mm	108	108	108	195	195
Measurement F	mm	315	585	585	585	585
Measurement G	mm	650	915	915	915	915
Measurement H	mm	100	100	100	100	100
Measurement X	mm	350	500	500	500	500
Noise level lower than	dB(A)	70				

N.B.: Levels of nominal noise. The levels can vary according to the environment where the central unit has been installed and the kind of installation.

INSTALLING THE CENTRAL UNIT

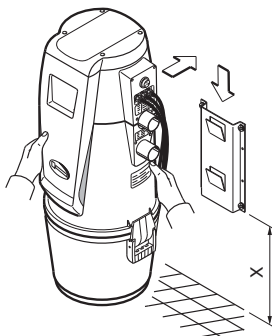

CONNECTION TO THE PIPING NETWORK

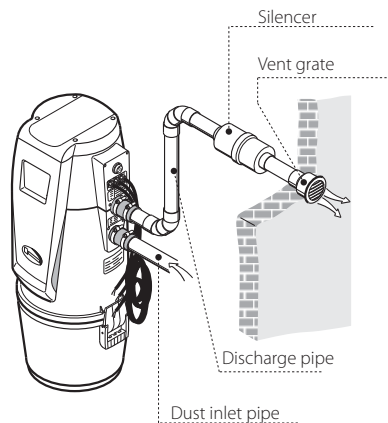

ELECTRIC CONNECTION

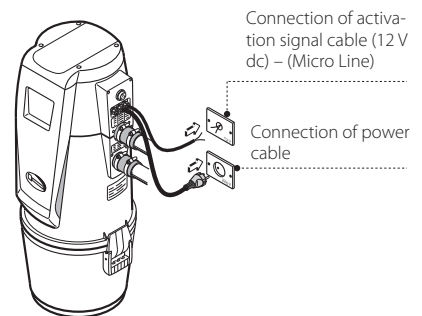

The central unit is mounted on the supplied mounting bracket. This must be securely and permanently fixed to a wall with appropriate plugs, considering that the overall weight can reach as much 7/8 times the weight of the central unit itself. (See Technical details).

N.B. The central unit should be placed allowing at least 10 cm space from the ground.





Two models for surfaces  up to 300 m²



The central vacuum cleaner Wolly 2 can be installed almost everywhere: thanks to the easy pre-installation it is always possible to find the right place to install it. With its sober and essential design this central vacuum unit is never misplaced.

Selection table



IP20



1 operator

The built in central vacuum unit Wolly 2 was designed to be installed inside as well as outside. It is possible to connect it to 40 mm (with maximum 3 inlets) or 50 mm pipes. The air discharge can be carried or frontal.

Maximum surface	MODEL	ARTICLE	Maximum inlet valves	Operators maximum	Vacuum attachment Ø (mm)	Air vent Ø (mm)	Dust bag capacity (l)	Filtering surface (cm ²)	Power supply (V ac)	Motor power (kW)	Maximum air flow (m ³ /h)
Max 150 m ²	Wolly2 150	8201.0	4	1	40/50	40/50	12	2840	220/240	1,3	170
Max 300 m ²	Wolly2 300	8201.1	7	1	40/50	40/50	12	2840	220/240	1,4	175

Special pre-installation Wolly 2

Installation SET



WOLLY 2 INSTALLATION SET

Complete pre-installation set for a central vacuum system with the central vacuum unit Wolly 2 in the built in version (with box and doors) and installation material for three inlets (50 mm pipes).

One more opportunity to install Wolly 2.

ARTICLE	PRODUCT DESCRIPTION	Packing Pcs
7030.3Y	WOLLY 2 INSTALLATION SET 3 INLETS	1



TECHNICAL FEATURES

The central vacuum cleaner Wolly 2 is designed and realized in conformity with all regulations in force and European directives but also takes great care of functionality, rationalization of the spaces, power and easiness of use.

Additional features:

- the air discharge can be frontal or carried.
- possible connection to the piping network from the right or the left.
- Soft Start system to reduce the motor consumption during the start up phase.
- filter cartridge in filter class L, in polyester, washable
- filtering bag in microfiber, 12 l capacity
- vacuum breaker valve to protect the motor
- single phase motors with brushes and direct cooling
- safety temperature sensor which protects the motor with automatic stop and start in case of problems.

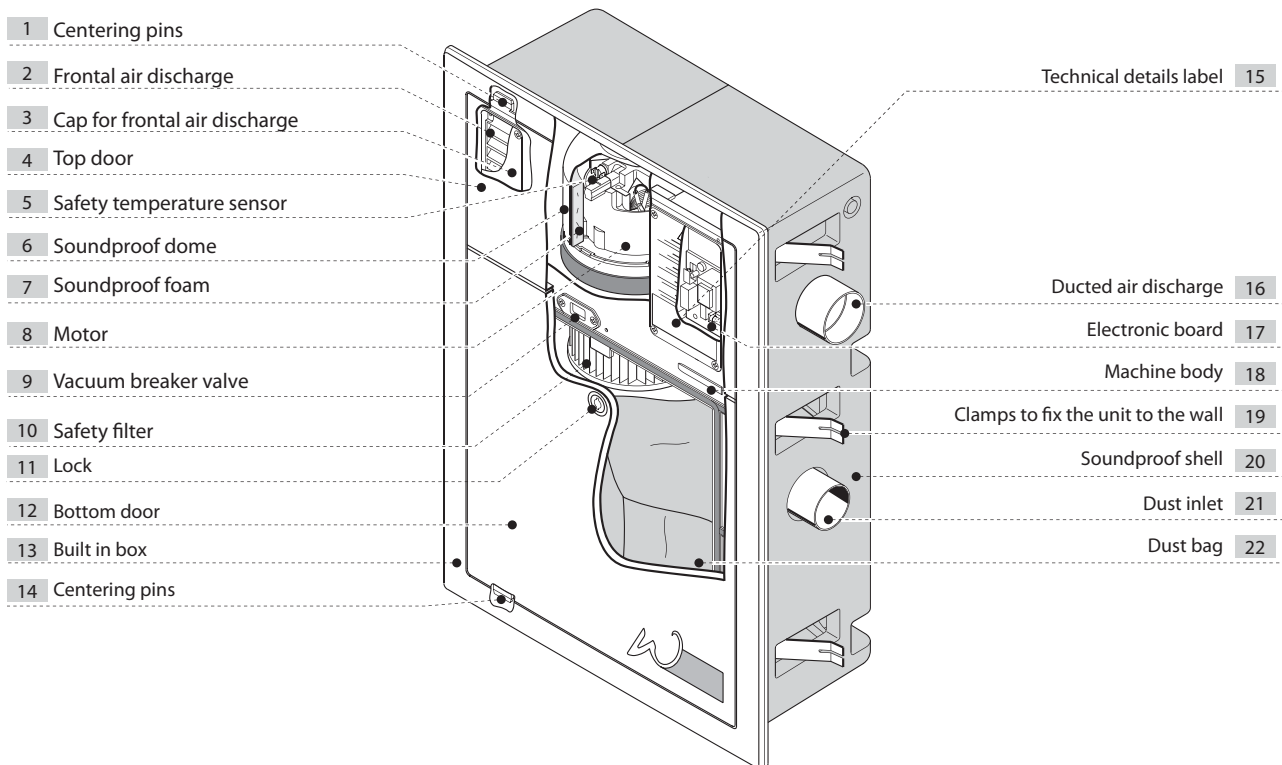

MESUREMENTS AND TECHNICAL DETAILS

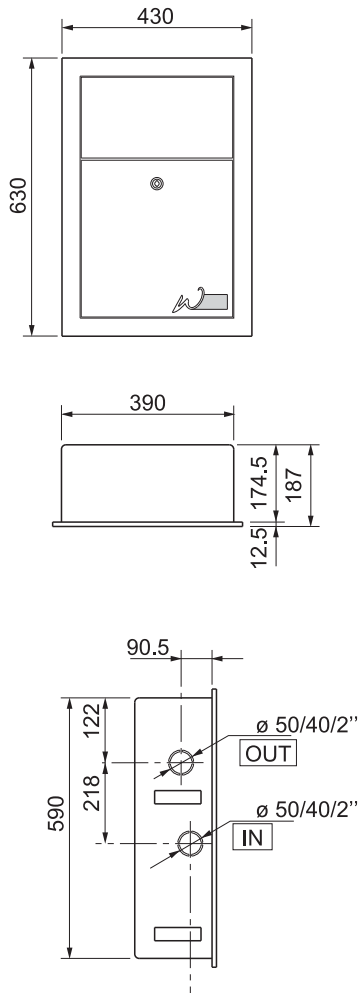

Model Article		Wolly 2	
		Wolly2 150	Wolly2 300
		8201.0	8201.1
Maximum surface	m ²	150	300
Power Supply	V ac	220/240	220/240
Frequency	Hz	50/60	50/60
Motor power	kW	1,3	1,4
Absorption	A	5,6	6,5
Inlets supply	V dc	12	12
Maximum depression	mmH ₂ O	2700	2900
Maximum air flow	m ³ /h	170	175
Security filter surface	cm ²	2840	2840
Dust container capacity	lt	12	12
Weight	kg	9	9
Width	mm	430	430
Height	mm	630	630
Depth	mm	187	187
Vacuum attachment	Ø mm	40/50	40/50
Exhaust attachment	Ø mm	40/50	40/50

INSTALLATION SOLUTIONS

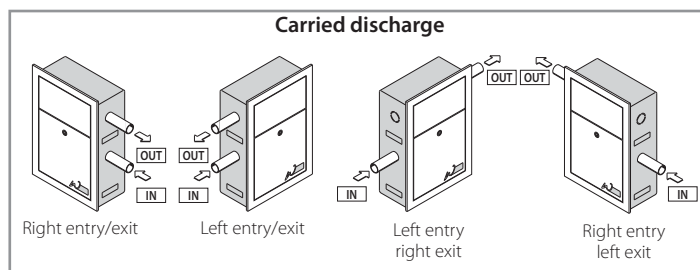
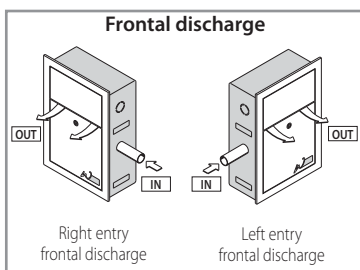



For surfaces  up to 120 m²



The connections to piping network, power supply and microline are made during the installation phase through the special template.



All connection are on the back of the central unit.



The system can be completed by plugging the central vacuum unit into the template, where all connections were previously wired.



With the accessory kit provided it is possible to perform all main cleaning activities in the house.

Selection table



IP44



1 operator

The compact central vacuum cleaner Sistem Cube was designed and realized for the use in domestic environments in which the available space is at a minimum, such as cupboards, basin cabinets or balconies. Thanks to the special piping network with reduced diameter it is possible to obtain a high vacuum power: the system cannot have more than three inlets.

Maximum surface	MODEL	ARTICLE	Maximum inlet valves	Operators maximum	Vacuum attachment Ø (mm)	Dust bag capacity (l)	Security filter	Power supply (V ac)	Motor power (kW)	Maximum air flow (m³/h)
Max 120 m²	Sistem Cube	8300.0	3	1	40	5	YES	220/240	1	178



Installation possibilities of the compact vacuum cleaner Sistem Cube



TECHNICAL FEATURES

The central vacuum cleaner Sistem Cube is designed and realized in conformity with all regulations in force and European directives but also takes great care of functionality, rationalization of the spaces, power and easiness of use.

Additional features:

- pre-installation template for the connection to the piping network (inlet and outlet) with pre-wired electric connections;
- connection to the piping network from the left or the right;
- filtering bag made of paper, 5 l capacity;
- washable safety filter;
- single phase motor with brushes and direct cooling;
- safety temperature sensor which protects the motor with automatic stop and start in case of problems.

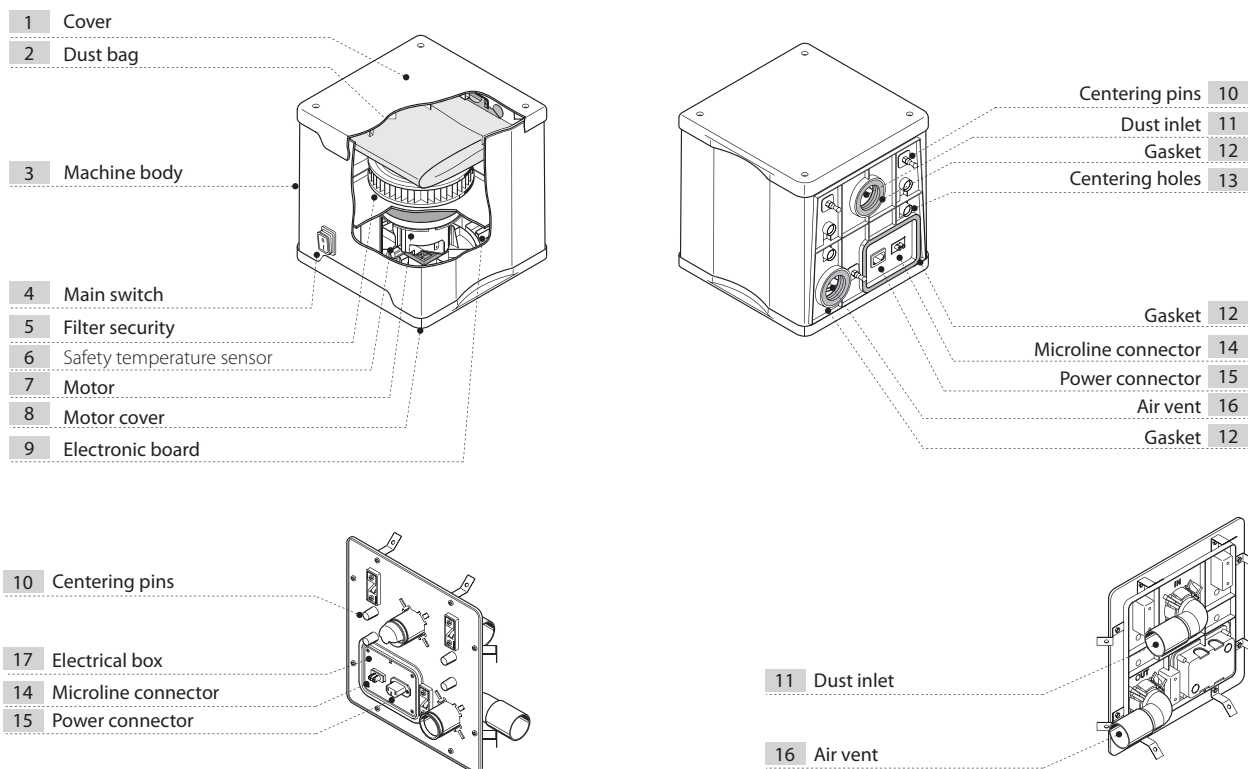

WIRING OF THE TEMPLATE

- 1 - Wire the connectors of the panel with the cables going out from the template.
- 2 - Screw the panel on the template taking care of the centring mark.

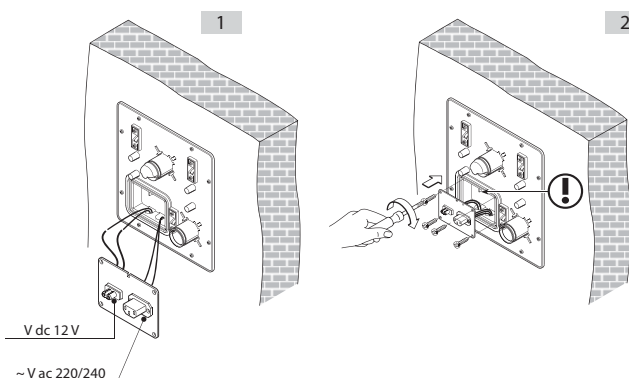

MEASUREMENTS AND TECHNICAL DETAILS

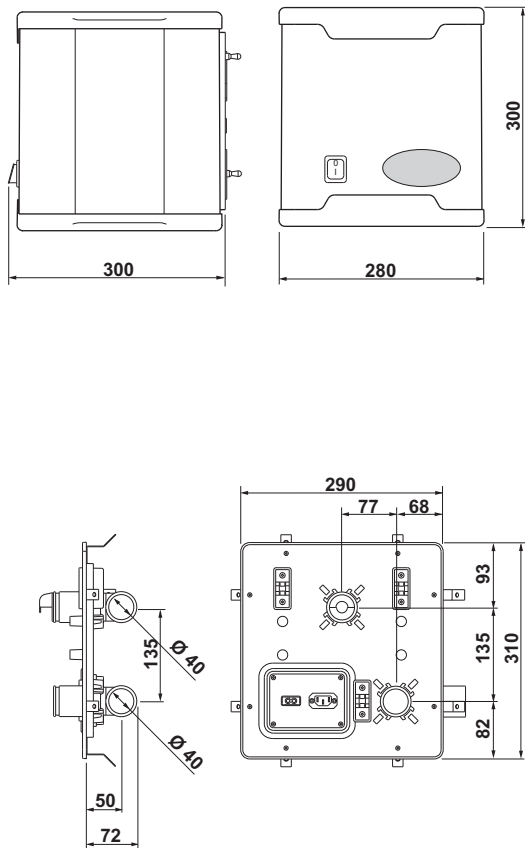

		Sistem Cube
Model Article	Sistem Cube	
		8300.0
Maximum number of operators		1
Maximum surface	m ²	120
Recommended inlets		3
Cleaning accessories Kit		SI
Power supply	V ac	220/240
Frequency	Hz	50/60
Motor power	kW	1
Absorption	A	4,5
Maximum capacity	m ³ /h	178
Supply sockets	V dc	12
Filter security		SI
Dust container capacity	lt	5
Weight	Kg	4
Width	mm	290
Height	mm	310
Depth	mm	290
Dust inlet pipe	Ø mm	40
Air vent	Ø mm	40
Noise level lower than	dB(A)	70

N.B.: Levels of nominal noise. The levels can vary according to the speed of use, the environment where the central unit is installed and the kind of installation.

FIXING OF THE UNIT

The central unit Sistem CUBE is to be inserted in the special template (art. 8300.10) which was first wired. While inserting the unit it is important to make the centering pins match with the holes on the unit and on the template.

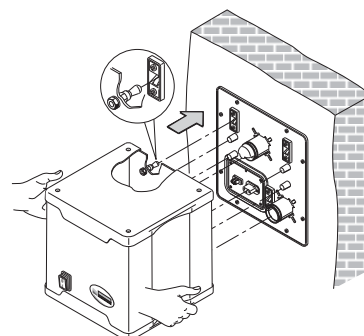



Two models for surfaces

up to 60 m²



The Jolly series was realized with an eye to compactness and easiness of use: the diagnostics of the central unit is simple and clearly visible, positioned near the inlet of the hose.



The replacement of the dust bag is simple and hygienic, thanks to the bag carrier and the closure string, which avoids that the vacuumed material comes out.



The box to fix the unit to the wall is quite compact and has a sober finishing.



The decorative frames give an elegant touch to the vacuum cleaner, which can easily be integrated with the furnishing of the room in which it is installed.

Selection table



IP20



1 operator

The absence of the piping network makes Jolly particularly suitable for the installation in pre-built houses and in all cases in which it is impossible to install a piping network. Each Jolly vacuum cleaner can clean a surface of about 60 square meters. Combining more vacuum cleaners, each of which can be positioned at pleasure depending on the installation needs, it is possible to clean any surface. It is also possible to install the central vacuum cleaner in the center of the apartment, on a partition wall, using the external box. If you wish to discharge the vacuumed air outside the house you can use the special kit for ducted discharge. The Jolly Contact version has the same characteristics as the basic Jolly unit, but it makes possible to start and stop the central vacuum cleaner by using the button on the handle of the hose.

Maximum surface	MODEL	ARTICLE	Maximum inlet valves	Operators maximum	Vacuum attachment Ø (mm)	Dust bag capacity (l)	Power supply (V ac)	Motor power (kW)	Maximum air flow (m ³ /h)
Max 45/60 m ²	JOLLY	8710.0	1	1	NO	3	220/240	1	178
	JOLLY Contact	8720.0	1	1	YES	3	220/240	1	178





TECHNICAL FEATURES

- Paintable external frame in ABS.
- Structure in plastic material propylene.
- Box for the dust bag for a cleaner and fast disposal.
- Dust bag with 3 l capacity.
- Signal that bag replacement is needed.
- Single phase motor with brushes.
- Safety temperature sensor to protect the motor with automatic stop and start.
- Connection for on-off hose (only Jolly Contact).

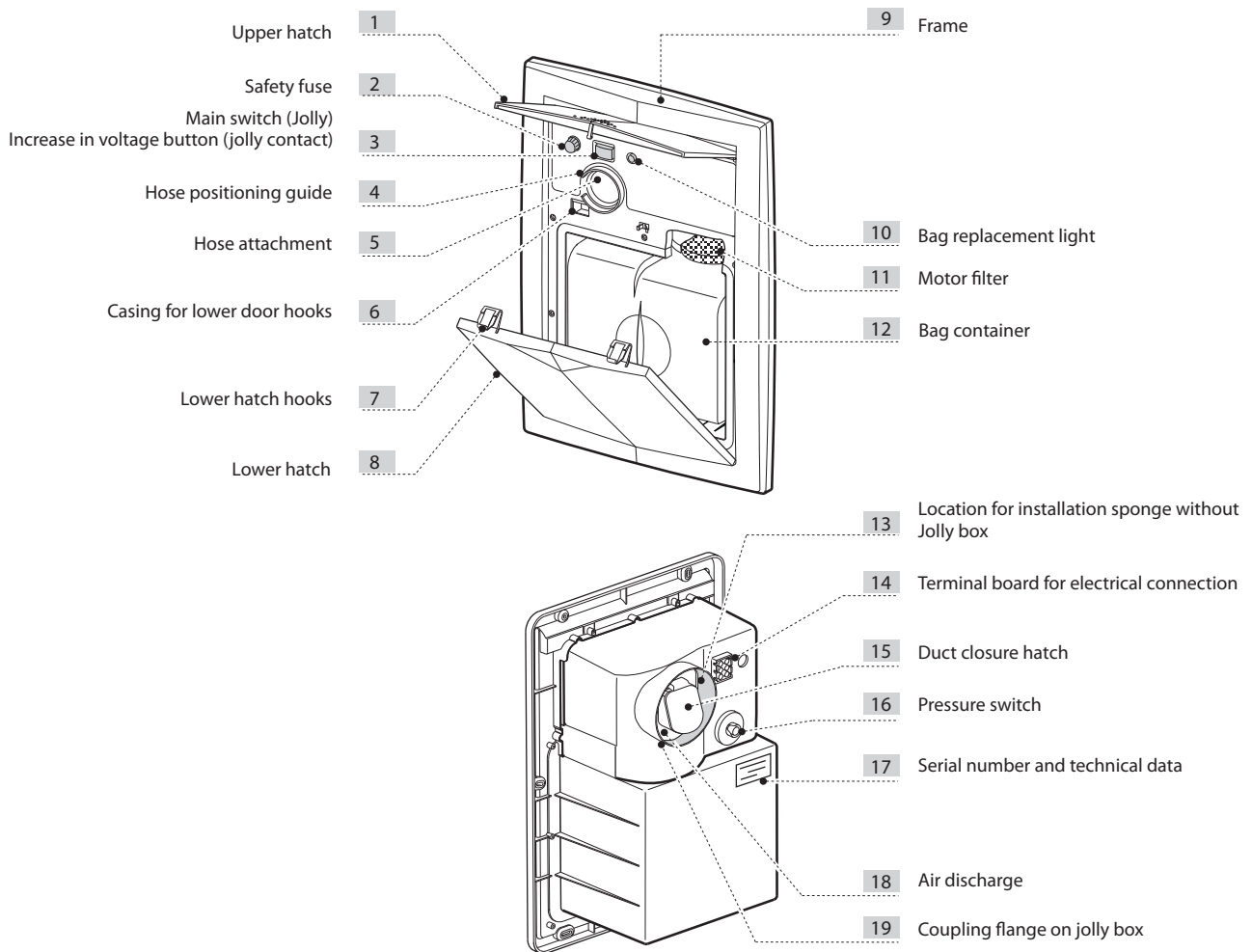

TRADITIONAL INSTALLATION

(with build-in box)

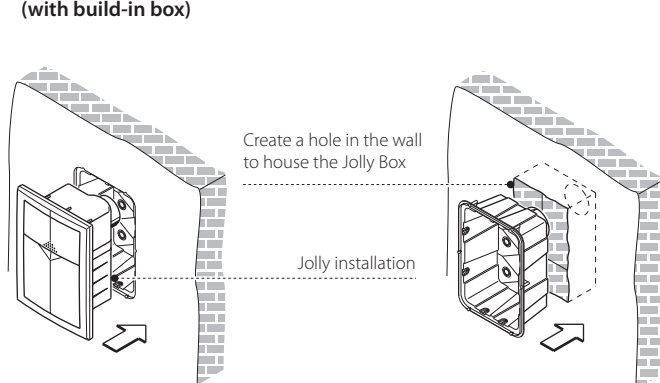

EXTERNAL INSTALLATION ON THE WALL

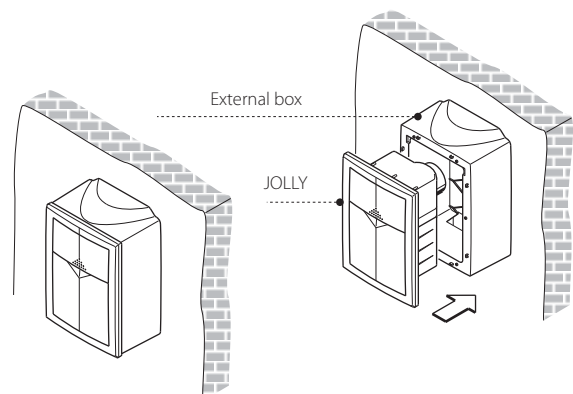

MEASUREMENTS AND TECHNICAL DETAILS

Art. 8710.0 Art. 8720.0
Size of Jolly / Jolly contact

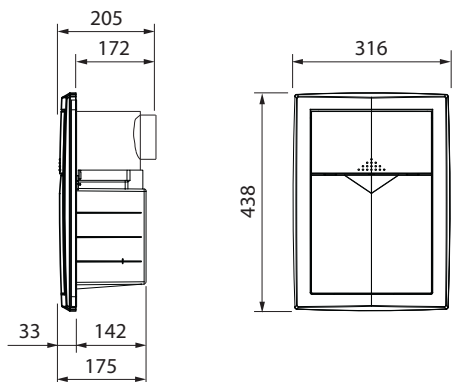

Model Article		Linea JOLLY	
		JOLLY	JOLLY Contact
		8710.0	8720.0
Attachment for low voltage hose		NO	YES
Dust inlet pipe	Ø mm	40	40
Insulation level	IP	20	20
Power	Volt ac	220/240	220/240
Frequency	Hz	50/60	50/60
Motor power	kW	1	1
Absorption	A	5	5
Supply to low voltage hose	Volt dc	-	12
Maximum air flow	m³/h	178,2	178,2
Protection fuse		WF 10A 250V	WF 10A 250V
Dust bag capacity	l	3	3
Air vent		SI	SI
Air discharge silencer		NO	NO
Weight	kg	3,8	3,8
Noise level lower than	dB(A)	70	

N.B.: Levels of nominal noise. The levels can vary according to the environment where the central unit is installed, and the kind of installation.

BASIC SET

It is a tool that allows the installation of Jolly in the centre of the house: equipped with air discharge to the outside, piping and accessories, it allows the air to be discharged to the outside.

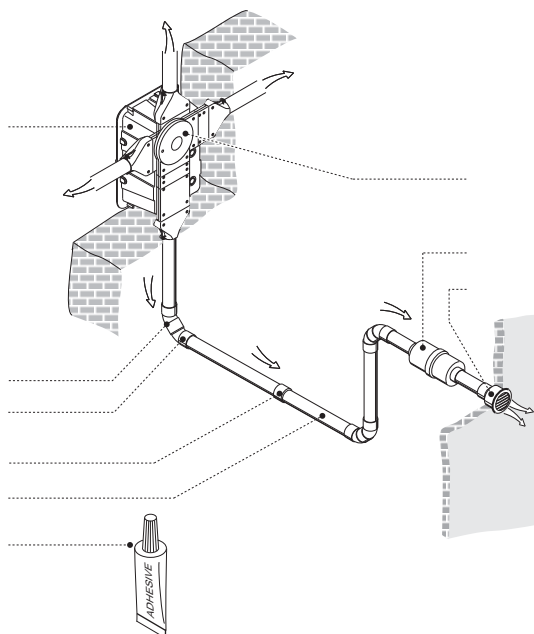

Material content in the basic set 8600.2

Rif	Article	Pcs.	Description
A	8500.0	1	Jolly wall box
B	8510.1	1	Side discharge
C	110001	1	PVC silencer
D	5050.4	1	Ø 50 vent grate
E	3050.0	4	Ø 50 45° M/F PVC elbow
F	3050.1	4	Ø 50 45° F/F PVC elbow
G	1150.1	6	Ø 50 F/F PVC sleeve
H	1850.0	9 mt.	Ø 50 PVC pipe
L	9225.3	1	Special glue (60g)





Attachments (reversible) from either right or left side



Tecno Star Dual power unit with automatic filter self cleaning



Dust container easy to manage



Control Interface system (detail)



TECNO Star

★ ★ Dual Power

Two operators simultaneously

Maximum cleaning surface  up to 450 m²

TECNO Star Dual Power a domestic vacuum unit with professional performances



ENERGY SAVING

The unit can work with an energy saving of 7% at the same suction power.

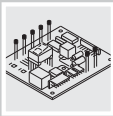

CUSTOMIZABLE SMART MANAGEMENT SOFTWARE

The Tecno Star Dual Power central unit provides the same advanced package for electronic and software management available on the new Tecno R-Evolution series; it includes many different safety controls set up by Sistem Air but customizable by the end user in order to assure very easy maintenance procedures.



THE PRECISION OF THE MAINTENANCE SYSTEM DETECTION

Many different control sensors send to the internal microprocessor all real central vacuum unit conditions; the unit display points out all malfunctions with the indications to restore the correct working conditions.

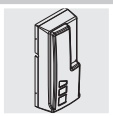

SELF-CLEANING OPTIONAL DEVICE

The Tecno Star Dual Power unit is prepared to receive the self-cleaning optional device, either during the installation phase or later on, with no need of further operations.

Central unit characteristics



up to 2 operators simultaneously

The TECNO Star Dual Power unit is recommended for residential installations with maximum surface to be cleaned up to 450 m², piping network with 50/63 mm diameter, and dust inlet with 63 mm diameter.

Additional characteristics:

- extreme reliability thanks to the vacuum breaker valve and to the Soft Start electronic board, which prevents that the motor works in critical conditions;
- "Turbo" function button to start up both motors with just one operator;
- user friendly display;
- basement coated with shockproof material;
- metal dust container with the special low-effort opening device and soft touch handle.

Overall surface area	MODEL	ARTICLE	Maximum inlet number	Maximum operators number	Computer maintenance	Dust container capacity litres	Filtering surface area cm ²	Power Supply Vac	Motor power kW	Maximum air flow m ³ /h
*Max 350 m ²	TECNO STAR Dual Power	3116.2TS	16	1+1	YES	62	17000	220/240	1,3x2	390
**Max 450 m ²										

(*) for two separate micro lines; (**) for one single micro line





TECHNICAL FEATURES

The central vacuum cleaners of the Tecno Star Dual Power series are designed and realized in conformity with all regulations in force and European directives but also take great care of functionality, power and easiness of use.

Additional features:

- possible connection of the pipes from the left or from the right;
- programmable computer to check and personalize the maintenance cycles with dedicated software which can signal that the dust container is full, the filter cartridge is to be cleaned and the motor needs maintenance;
- soundproof motor cage;
- Filter cartridge in filter class L, in polyester, washable
- High capacity dust container with wheels that makes its handling easy
- single phase motors with brushes and direct cooling;
- Safety temperature sensor which protects the motor with automatic stop and start in case of problems.

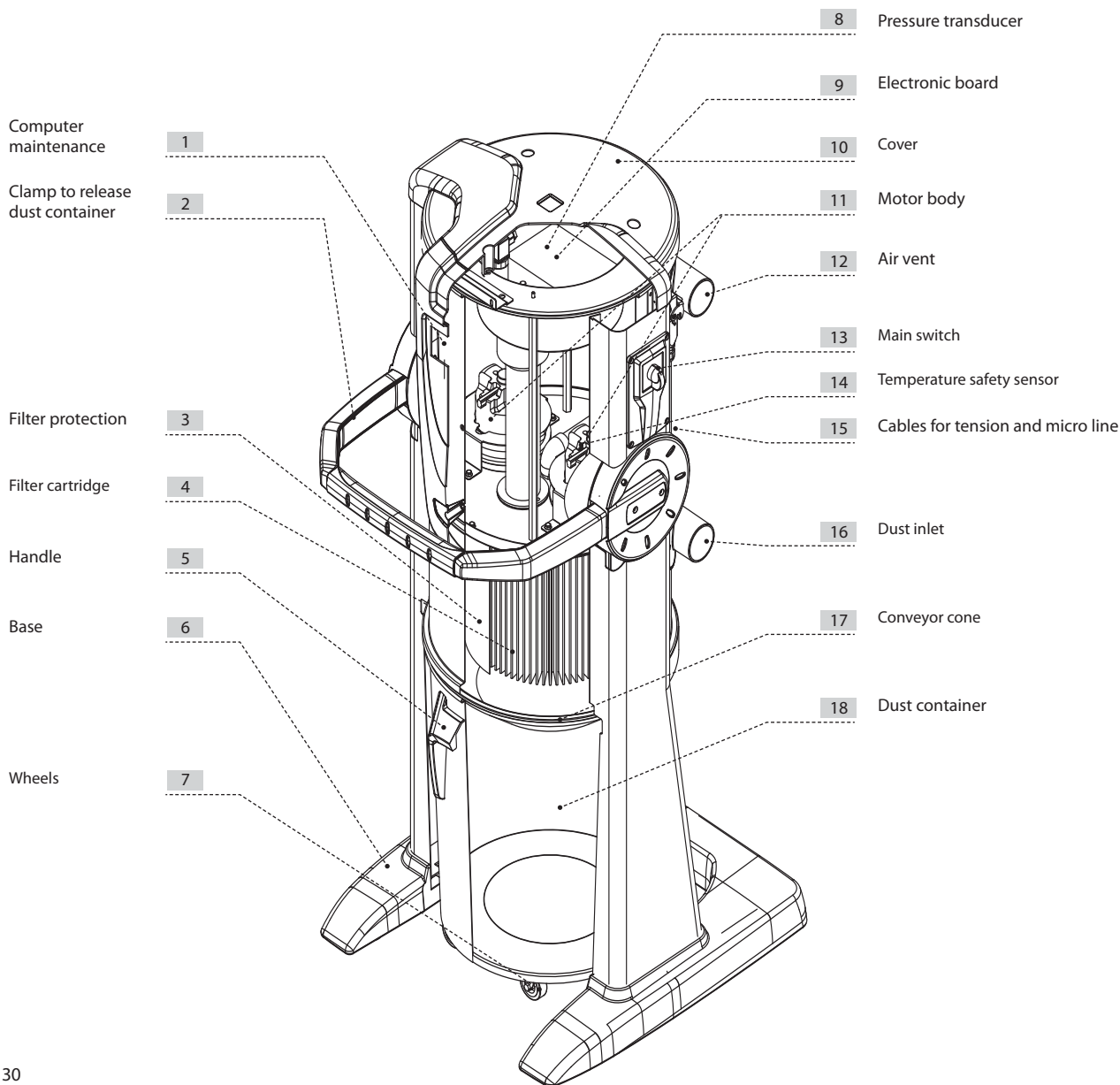

MEASUREMENTS AND TECHNICAL DETAILS

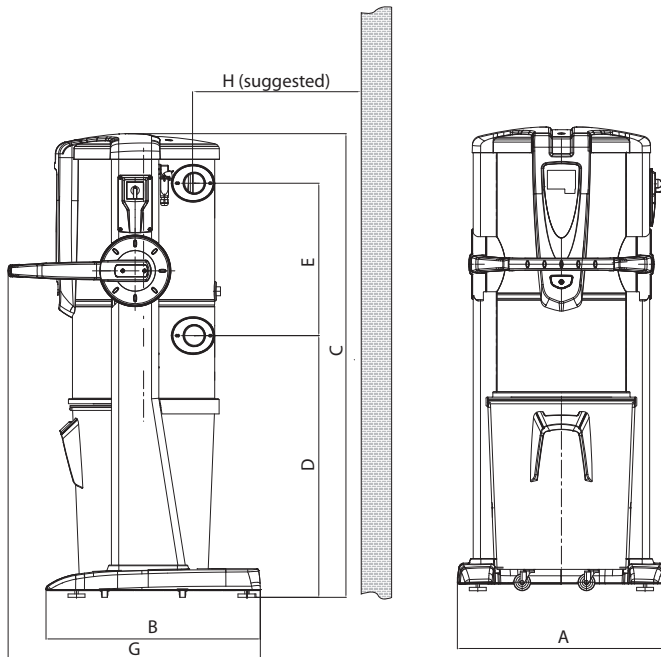

TECNO Star Dual Power series		
Model Article	TECNO Star Dual Power	
	3116.2TS	
Computer maintenance		YES
Dust inlet pipe	Ø mm	63
Air vent	Ø mm	63
Insulation level	IP	20
Power	Volt ac	220/240
Frequency	Hz	50/60
Motor power	kW	1,3x2
Absorption	A	12
Socket dc power supply	Volt dc	12
Maximum air flow	m³/h	390
Filtering surface	cm²	17000
Dust container capacity	l	62
Air vent		YES
Air discharge silencer		NO
Weight	kg	55
Measurement A	mm	615
Measurement B	mm	633
Measurement C	mm	1369
Measurement D	mm	773
Measurement E	mm	450
Measurement G	mm	745
Measurement H	mm	500
Noise level with 1 motor	dB(A)	64
Noise level with 2 motors	dB(A)	69

FITTING THE CENTRAL UNIT

The central vacuum unit do not need any particular fixing. Nonetheless it is necessary to check that the area where the central unit is to be installed comply with these minimum requisites:

- a firm and completely flat horizontal surface;
- the surface should not be subject to vibrations.

Moreover it is fundamental that the surface is not in a bad condition to avoid that the central unit becomes unsteady.

CONNECTION TO THE PIPING NETWORK:

The connections to the piping network and to the air vent can be positioned on the right or on the left side of the central unit.

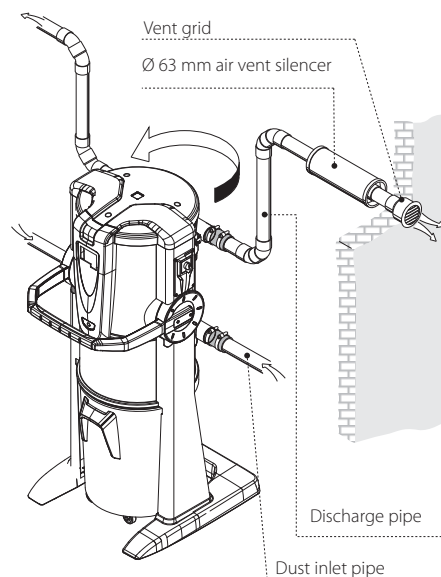



Professional and industrial range: Affinities of the different models

ENGINEERING, SIMPLIFICATION AND RATIONALIZATION:

Three concepts which involve a long project

The **new professional range by Sistem Air** was born with a specific engineering project to give an answer to all market requirements and challenges.

PRODUCT ENGINEERING: all new products of Sistem Air are conceived to offer the **maximum uniformity** regarding both production and design. The extreme standardisation of components has greatly increased the **reliability** and **quality** of the products, establishing a new market improvement.

PRODUCT SIMPLIFICATION: this means an increase in the **ease of use** not only **for the end user** but also **and above all during the installation phase**. The new electronic control system, which is a standard equipment on the whole professional and industrial range, is able to detect automatically, **without using any resistive dividers or specific control panels**, the total simultaneous users working on the network.

Now you can install an industrial system with the same easiness of a domestic one.

POWER RATIONALIZATION: the new software package and the new electronic board installed on all new central vacuum units are able to assure to the end user the best possible performance at the desired suction power; the system automatically maintains the power level also when new operators enter in the network. In this way **the motors consume just the necessary energy supply** able to grant the requested performance without any wastes.





Why ENERGY SAVING is important

The new product range of Sistem Air has been specifically conceived to significantly reduce the environmental impact both during production and use. The whole professional and industrial range is fitted with a very sophisticated electronic system able to assure the necessary energy supply to the motors, with a considerable energy saving compared to the past.



Small Professional applications



offices, sport centers, beauty shops, workrooms, farms, gyms, fitness centers and workshops



Attachments (reversible) from either right or left side



Revo Block Professional central unit with Autocleaner



Control switch and wiring panel



revo block
professional

Maximum cleaning surface 1800 m²

Revo Block professional strength and technology



PROFESSIONAL PERFORMANCES

No time limit of running, 24 hours a day, ensuring always a considerable aspiration power.

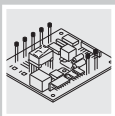

CUSTOMISED MAINTENANCE AND CONSUMPTION MANAGEMENT

Revo Block Professional product range is fitted with a continuous monitoring system, exclusive of Sistem Air, able to assure the complete customisation of the central unit: you can choose the suction power and maintenance schedule. Everything with an extreme simplicity.

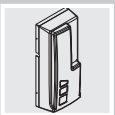

AUTOCLEANER OPTIONAL DEVICE

All central units of the Revo Block Professional range are prepared for the installation of the Autocleaner optional device, which can be added either during the installation phase or later on, with no need of further operations.

Central Unit Selection Table



Max 3 operators simultaneously

The Revo Block Professional range is suitable for professional applications with a maximum area to be cleaned up to 1800 m², piping system with 63/80 mm diameter and dust inlet/outlet pipes of 63/80 mm diameter.

Additional characteristics:

- extreme reliability thanks to the vacuum breaker valve which prevents that the motor works in critical conditions;
- possibility to connect the unit to a PC with a specific software package to visualize the diagnostics (with an optional electronic interface board);
- user-friendly display;
- basement coated with shockproof material;
- dust container with special low-effort opening device and soft touch handle.

Overall surface area	MODEL	ARTICLE	Maximum operators number	Self-cleaning prearrangement	Motor power kW	Power Supply phases/V ac	Maximum air flow m ³ /h	Filtering surface area cm ²	Dust container capacity litres
Max 500 m²	Revo Block Professional 500	3201.1B	1	YES	1,5	2-220/240	219/265	17000	62
Max 700 m²	Revo Block Professional 700	3201.2B	1	YES	2,2	3-400	304	17800	106
Max 1000 m²	Revo Block Professional 1000	3201.3B	2	YES	2,2	2-220/240	304/366	17800	106
Max 1200 m²	Revo Block Professional 1200	3201.4B	2	YES	2,2	3-400	304/366	17800	106
Max 1500 m²	Revo Block Professional 1500	3201.5B	2	YES	4	3-400	304/366	17800	106
Max 1800 m²	Revo Block Professional 1800	3201.6B	3	YES	4	3-400	414/500	17800	106





TECHNICAL FEATURES

The central vacuum cleaners of the Revo Block Professional series are designed and realized in conformity with all regulations in force and European directives but also take great care of functionality, power and easiness of use.

Additional features:

- possible connection of the pipes from the left or from the right;
- programmable computer to check and personalize the maintenance cycles with dedicated software which can signal that the dust container is full, the filter cartridge is to be cleaned and the motor needs maintenance;
- filter cartridge with large filtering surface, in filter class L, in polyester, washable;
- high capacity dust container with wheels that make its handling easy;
- motor-pump group with professional motor with CE mark, IP 55 class, insulation class F, with integrated silencer

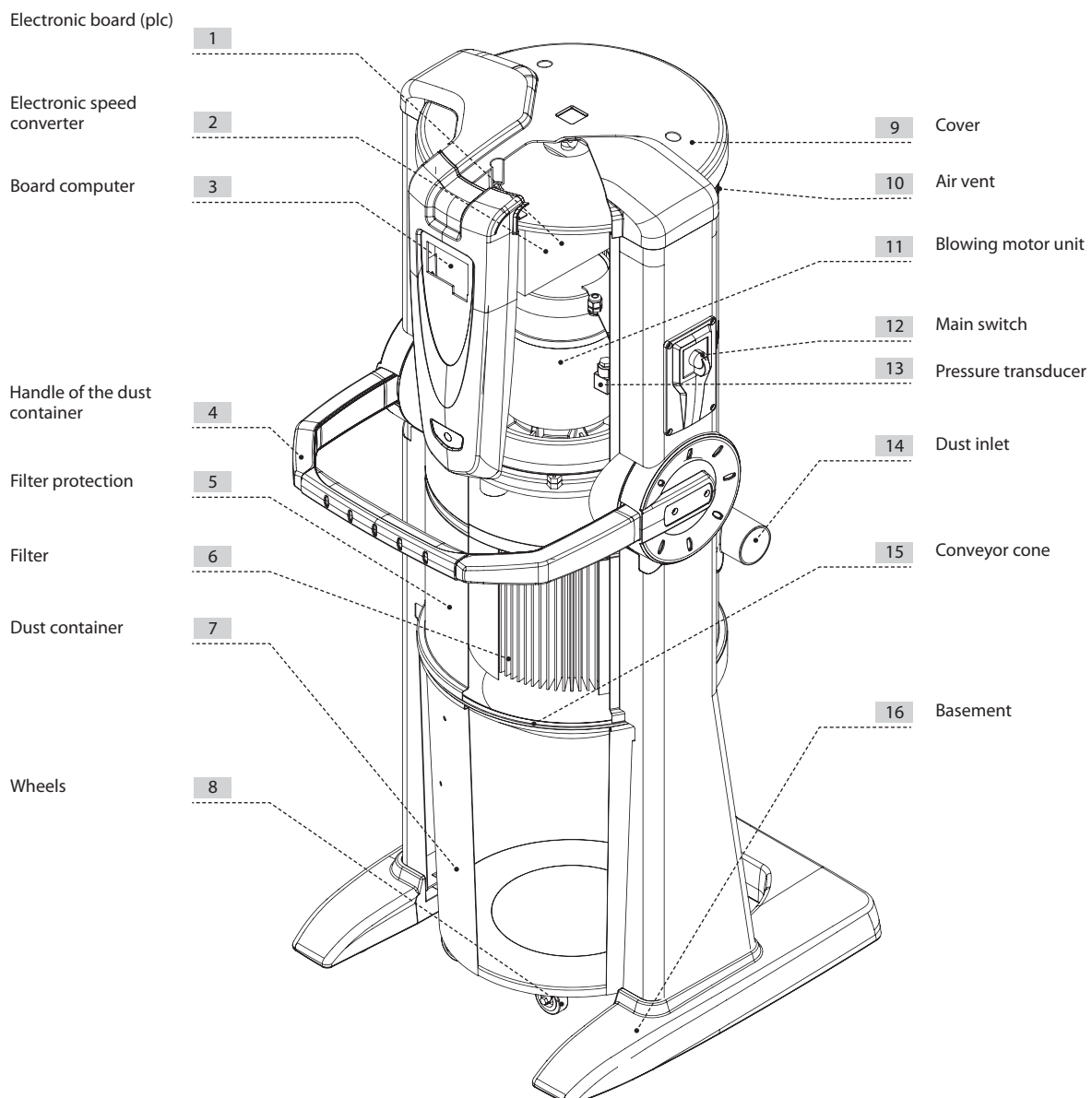

MEASUREMENTS AND TECHNICAL DETAILS

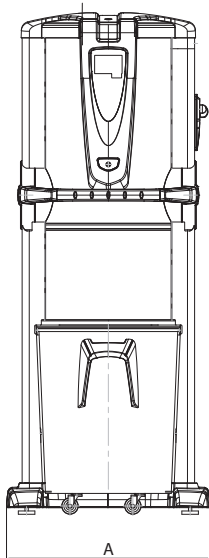
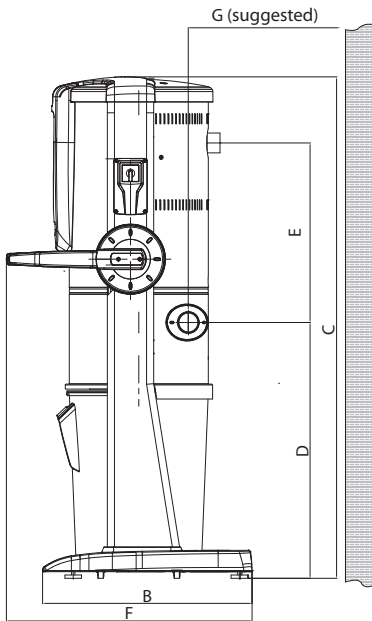

Model Article		Revo Block Professional					
		Revo Block 500	Revo Block 700	Revo Block 1000	Revo Block 1200	Revo Block 1500	Revo Block 1800
		3201.1B	3201.2B	3201.3B	3201.4B	3201.5B	3201.6B
Computer maintenance		YES	YES	YES	YES	YES	YES
Vacuum attachment	Ø mm	63	63	63	63	63	80
Air exhaust	Ø mm	63	63	63	63	63	80
insulation level	IP	20	20	20	20	20	20
Supply	Volt ac	220/240	400	220/240	400	400	400
Frequency	Hz	50/60	50/60	50/60	50/60	50/60	50/60
Motor power	kW	1,5	2,2	2,2	2,2	4	4
Absorption	A	5,7	5,1*	8,8	5,1	9,2	9,2
Supply sockets	Volt dc	12	12	12	12	12	12
Electronic speed changer		YES	NO	YES	YES	YES	YES
Portata massima aria	m³/h	265	304*	366	366	471	570
Filtering surface areas	cm²	17000	17800	17800	17800	17800	17800
Dust container capacity	l	62	106	106	106	106	106
Air vent		YES	YES	YES	YES	YES	YES
Air discharge silencer		NO	NO	NO	NO	NO	NO
Weight	kg	75	95	95	95	105	115
Measurement A	mm	615	750	750	750	750	750
Measurement B	mm	633	633	633	633	633	633
Measurement C	mm	1515	1616	1616	1616	1616	1616
Measurement D	mm	773	773	773	773	773	773
Measurement E	mm	542	642	642	642	642	642
Measurement F	mm	750	750	750	750	750	750
Measurement G	mm	500	500	500	500	500	500
Noise level of motor	dB(A)	60÷80					

(*) Frequency 50 Hz

N.B.: Levels of nominal noise. The levels can vary according to the speed of use, environment where the central unit has been installed and the kind of installation.

Fixing of the central unit

The connections to the piping network and to the air vent can be positioned on the right or on the left side of the central unit.

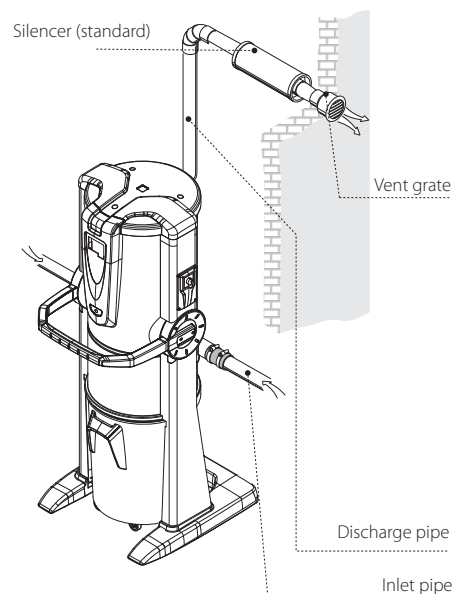



Industrial Clean

big/small

Strength and technology =

Industrial Clean Industrial Motor

No limits modular system



Industrial Motor

Maximum aspiration power





Industrial Clean

strong professional competence

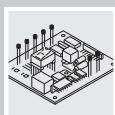

CUSTOMISED MAINTENANCE AND CONSUMPTIONS MANAGEMENT

The dust separator becomes the central control unit of the complete industrial system. The motors connected to the separator are adjusted by the electronic supervising board placed inside the separator, that manages its power and its start up, according to the user parameters. This procedure grants great flexibility, in a simple way.



AUTOCLEANER OPTIONAL DEVICE

Our dust separator range is prepared for the installation of the Autocleaner optional device, either during the installation phase or later on, with no need of further operations.



Dust separator with Autocleaner



Connections (reversible) from either right or left side



Central Unit Selection Table



piping network 80/100 mm Ø

The dust separators of the new Industrial Clean range are suitable for any industrial application. They should be combined with a piping network of the correct size suitable to manage the number of simultaneous operators requested.

Additional characteristics:

- extreme reliability thanks to the vacuum breaker valve which prevents that the motor works in critical conditions;
- possibility to connect the unit to a PC with a specific software package to visualize the diagnostics (with an optional electronic interface board);
- user-friendly display;
- basement coated with shockproof material;
- dust container with special low-effort opening device and soft touch handle.

Maximum air flow	MODEL	ARTICLE	Max operators number with 32 Ø flex	Max operators number with 40 Ø flex	Computer manutenzione	Dust container capacity litres	Selfcleaning prearrangement	Filtering surface area cm ²	Alimentazione Volt ac
Up to 700 m ³ /h	Industrial Clean Small	3400.0	4	3	YES	62	YES	24000	220/240
Up to 1200 m ³ /h	Industrial Clean Big	3400.1	8	4	YES	106	YES	43400	220/240

MEASUREMENT TABLES AND TECHNICAL DATA

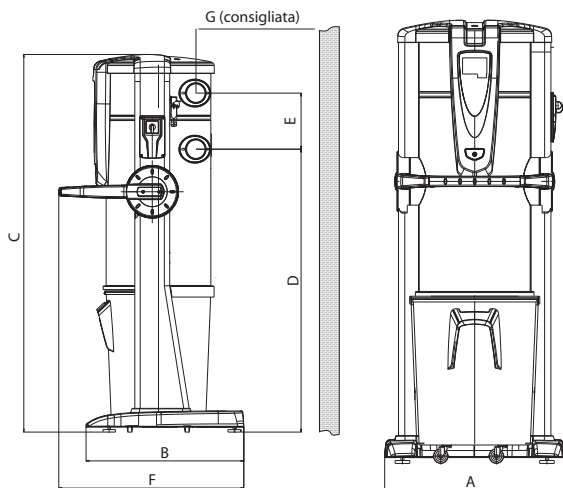

Model Article		Industrial Clean	
		Industrial Clean Small	Industrial Clean Big
		3400.0	3400.1
Software to manage motor		YES	YES
Vacuum breaker safety valve	Ø mm	YES	YES
Insulation level	IP	-	-
Power	Vo It ac	220/240	220/240
Frequency	Hz	50/60	50/60
Maximum air flow	m ³ /h	700	1200
Filtering surface areas	cm ²	24000	43400
Dust container capacity	l	62	106
Weight	kg	53	67
Measurement A	mm	615	750
Measurement B	mm	633	633
Measurement C	mm	1515	1616
Measurement D	mm	1135	1148
Measurement E	mm	281	281
Measurement F	mm	745	745
Measurement G	mm	500	500
Measurement M (air inlet)	mm	80	100
Measurement N (air outlet)	mm	80	100

TECHNICAL FEATURES

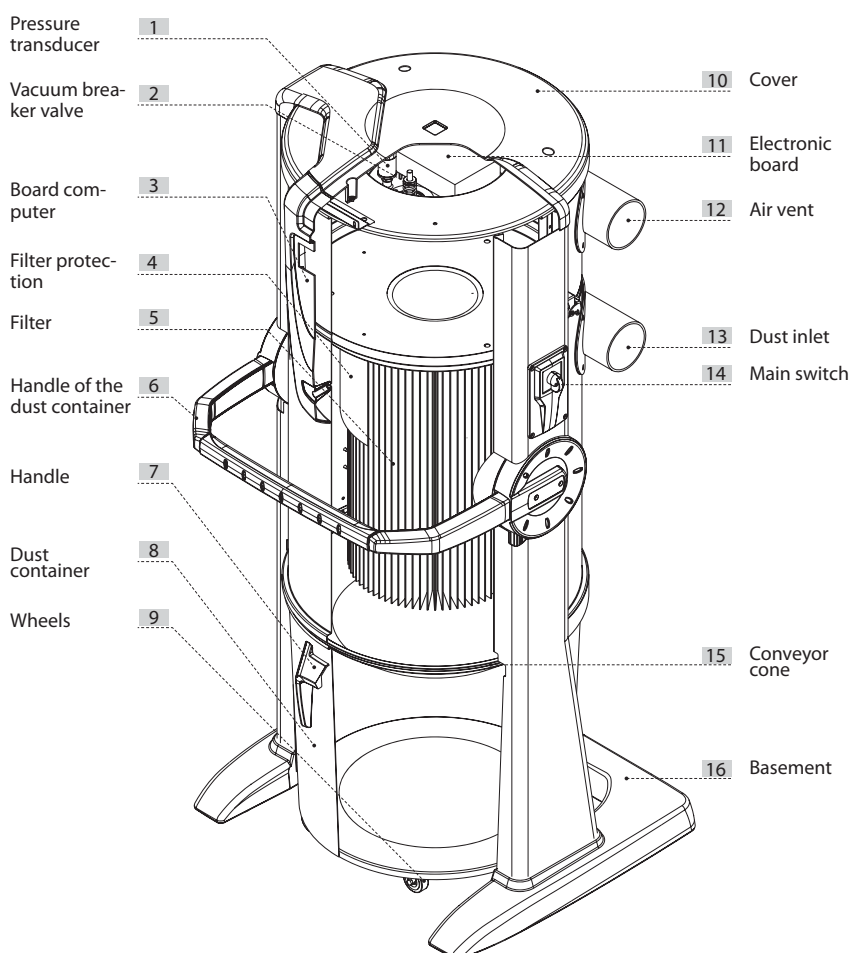

The dust separators of the Industrial Clean series are designed and realized in conformity with all regulations in force and European directives but also take great care of functionality and easiness of use.

Additional features:

- possible connection of the pipes from the left or from the right;
- programmable computer to check and personalize the maintenance cycles with dedicated software which can signal that the dust container is full, the filter cartridge is to be cleaned and the motor needs maintenance;
- filter cartridge with large filtering surface, in filter class L, in polyester, washable;
- high capacity dust container with wheels that make its handling easy.





Industrial Motor always reliable



PROFESSIONAL PERFORMANCES

No time limit of running, 24 hours a day, ensuring always a considerable suction power.

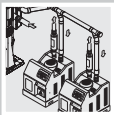

MODULAR SYSTEM

The different motors can be combined to reach the requested power, without any limit regarding the surface to be cleaned or the number of simultaneous operators.



Blowing Motors selection table

The blowing motors of the new Industrial Motor range are suitable for any professional /industrial application with no limit regarding the surface to be cleaned or the number of simultaneous operators. The piping network has to be realised according to the specific features of the installation (e.g. pipes diameter and dust to be vacuumed).

Additional characteristics:

- three phase industrial motors with maintenance free blowing device with side channels made of light alloy;
- serial board interface to connect every motor to the separator.

Maximum operators number	MODEL	ARTICLE	Speed electronic converter	Maximum air flow m ³ h	Motor Power kW	Power Supply phases/V AC	Absorption A
1	Industrial Motor U1	3500.1M	NO	304	2,2	3 /400	5,1
	Industrial Motor U1 Matic	3500.2M	YES	366	2,2	3 /400	5,1
2	Industrial Motor U2	3500.3M	NO	304	4	3 /400	9,2
	Industrial Motor U2 Matic	3500.4M	YES	366	4	3 /400	9,2
3	Industrial Motor U3	3500.5M	NO	536	5,5	3 /400	11,3
	Industrial Motor U3 Matic	3500.6M	YES	740	5,5	3 /400	11,3
4	Industrial Motor U4 Matic	3500.7M	YES	914	7,5	3 /400	15,1

MEASUREMENT TABLES AND TECHNICAL DATA

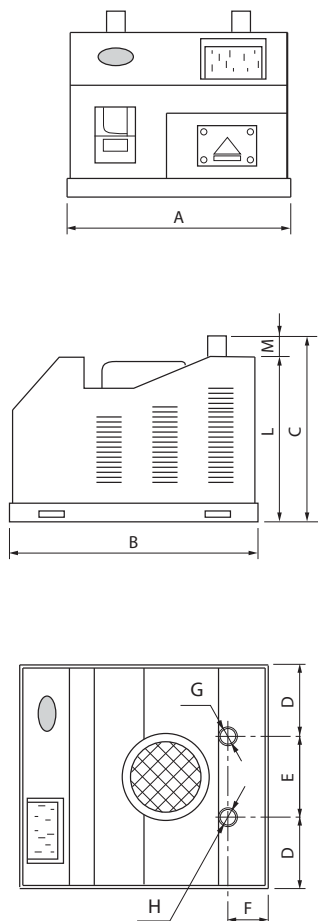

Linea Industrial Motor								
Model Article		U1	U1 Matic	U2	U2 Matic	U3	U3 Matic	U4
		3500.1M	3500.2M	3500.3M	3500.4M	3500.5M	3500.6M	3500.7M
Electronic speed converter		NO	YES	NO	YES	NO	YES	YES
Insulation level	IP	20	20	20	20	20	20	20
Power	Phasen/Volt ac	3/400	3/400	3/400	3/400	3/400	3/400	3/400
Frequency	Hz	50/60	50/60	50/60	50/60	50/60	50/60	50/60
Motor power	kW	2,2	2,2	4	4	5,5	5,5	7,5
Absorption	A	5,1*	5,1	9,2*	9,2	11,3*	11,3	15,1
Socket supply	Volt dc	12	12	12	12	12	12	12
Maximum air flow	m ³ /h	304*	366	304*	366	536*	740	914
Air vent		YES	YES	YES	YES	YES	YES	YES
Weight	kg	58	68	79	89	110	120	125
Measurement A	mm	40	540	540	540	595	595	595
Measurement B	mm	690	690	690	690	810	810	810
Measurement C	mm	600	600	640	600	800	800	830
Measurement D	mm	190	190	175	190	202,5	202,5	182,5
Measurement E	mm	160	160	190	160	190	190	230
Measurement F	mm	140	140	100	140	140	140	130
Measurement G air inlet	mm	60	60	80	60	80	80	100
Measurement H air outlet	mm	60	60	80	60	80	80	100
Measurement L	mm	580	580	580	580	750	750	750
Measurement M	mm	20	20	60	20	50	50	80
Noise level	dB(A)	60 ÷ 80						

(*) Frequency 50 Hz

N.B.: Levels of nominal noise. The levels can vary according to the speed of use, environment where the central unit has been installed and the kind of installation.

TECHNICAL FEATURES

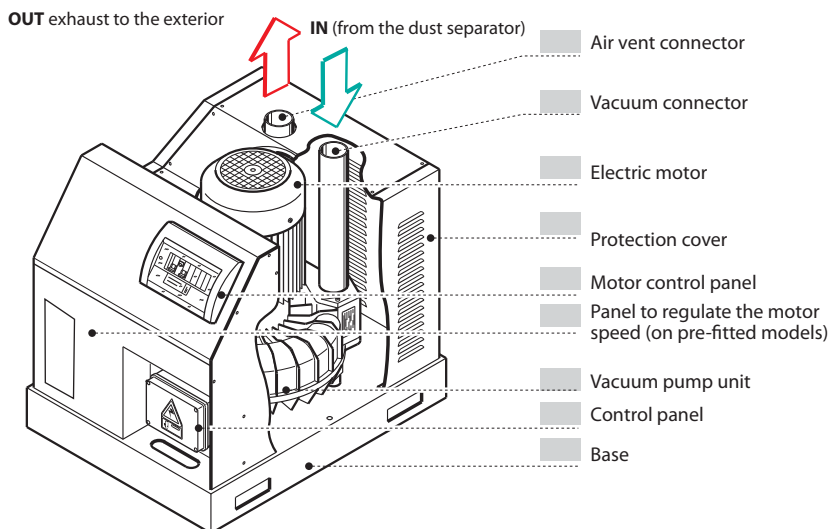

The blowing motors of the Industrial Motor series are designed and realized in conformity with all regulations in force and European directives but also take great care of functionality, power and easiness of use.

Additional features:

- motor-pump group with professional motor with CE mark, IP 55 class, insulation class F, with integrated silencer
- Circuit breaker near the control board
- Electronic speed converter with self ventilation and safety system to protect the unit.



You can install it where and when you want!



Inner detail of Self-cleaner device

Autocleaner

universal system

SISTEMA AIR

SUITABLE FOR THE FOLLOWING MODELS

- Tecno Star Dual Power
- Revo Block Professional (complete range)
- Industrial Clean (complete range)

Autocleaner:

Universal self-cleaning system

UNIVERSAL AUTOCLEANER DEVICE - code 3600.0U



The innovative Sistem Air Autocleaner device has been studied to be installed on all models of the new professional and industrial products range. You can install it during the installation phase or later on. The electronic supervising control recognizes the Autocleaner automatically. It is enough to give the consent to the execution of the program already installed inside the central unit or then modify the parameters as needed. The air connection is made through a specific hose whereas the electrical connection is made through a specific multipolar male cable (supplied with the unit) that must be connected to the female inlet of the central unit.



Autocleaner assembly



Just plug the connector in and Autocleaner is ready for use!

Electrical wiring



Pneumatic connection



Air compressor (detail)

Autocleaner



The automatic filter cleaning system Autocleaner of Sistem Air was born to answer to the product standardization needs expressed by the market. Solidity, easy installation and versatility make it a revolutionary product in the field of central vacuum systems.

ARTICLE	PRODUCT DESCRIPTION	Packing Pcs
3600.0U	Self cleaning system Autocleaner Universal System	1



TECHNICAL FEATURES

The automatic filter cleaning system Autocleaner of Sistem Air was born to answer to the product standardization needs expressed by the market. Solidity, easy installation and versatility make it a revolutionary product in the field of central vacuum systems.

Its main technical features can be summarized as follows:

- Powder coated solid metal casing;
- Elegant cover in thermoformed plastic material;
- Multipolar plug connection with guided clutch;
- Tap for condensation discharge;
- Safety valve for the discharge of the air contained in the cylinder;
- Maintenance free dry compressor;
- Fixing clamp included;
- Ready to be used thanks to the program preinstalled in the microprocessor of central vacuum cleaners and separators;
- Mechanical and electrical safety (timeout of the system and lack of tension).

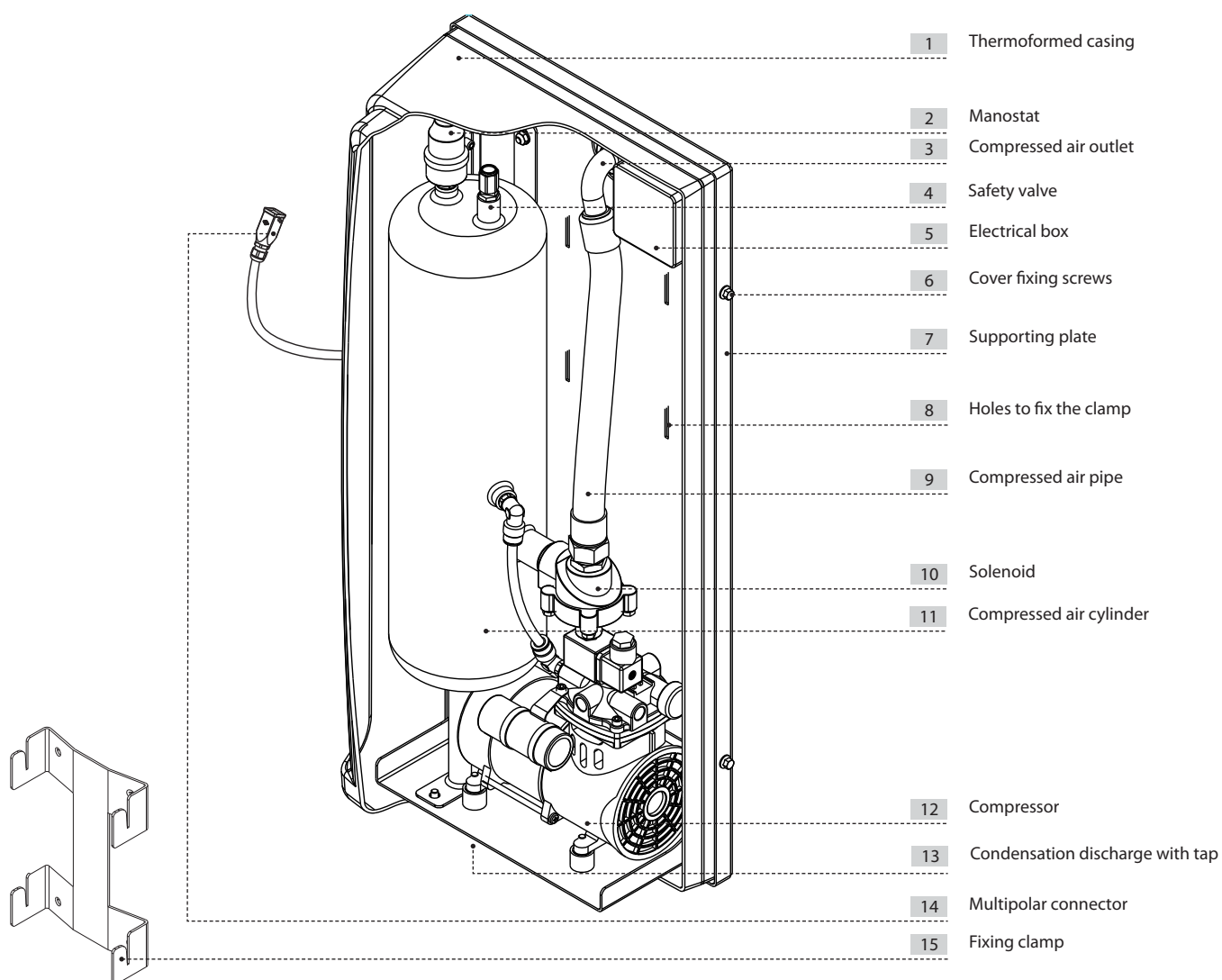

MEASUREMENTS AND TECHNICAL DETAILS

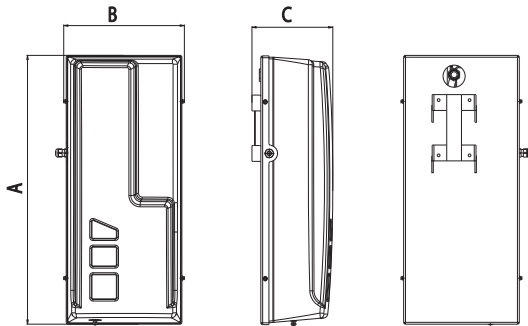

Autocleaner		
Model Article	Autocleaner	
	3600.0U	
Air output	Ø"	3/4
Insulation level	IP	40
Power supply	Volt ac	220/240
Frequency	Hz	50/60
Power	W	250
Absorption	A	1,3
Air pressure	bar	3,5
Air capacity	l	6
Measurement A	mm	730
Measurement B	mm	328
Measurement C	mm	220

INSTALLATION

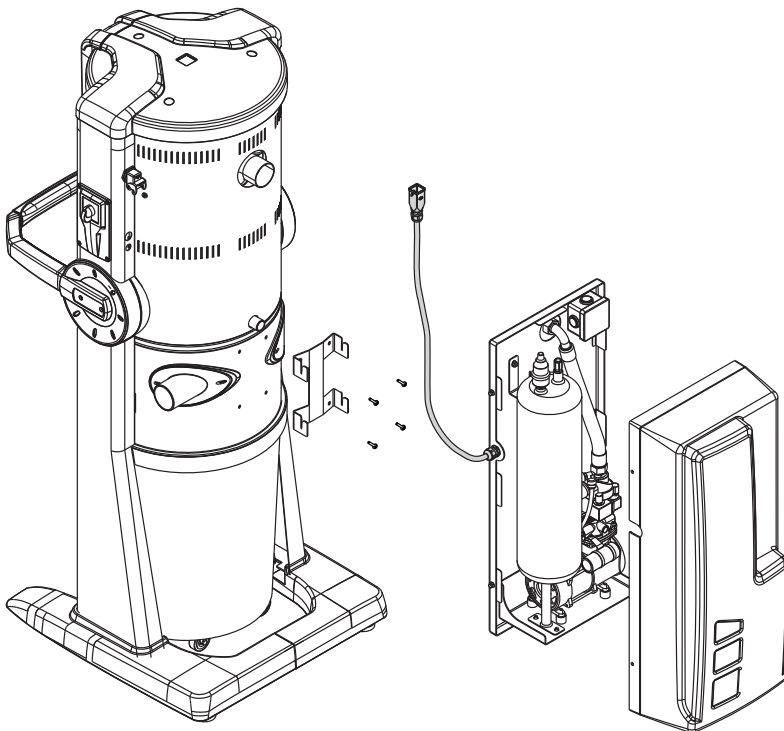

- 1 - Remove the four screws on the back of the cylinder and use them to fix the support clamp provided with the Autocleaner.
- 2 - Fasten the self cleaning system to the support and make the electrical and the pneumatic connections.



INSTALLATION KIT Ø 50 mm

The installation kit includes everything needed to fit a central vacuum system. The installation kits can be combined to obtain the number of inlets you wish to install. (e.g.: an 8 inlets system can be created by combining 1 kit with 3 inlets + 1 kit with 5 inlets; alternatively, 2 kits with 4 inlets each can be used). The list of material contained in the kit can be checked in the tables below.

N.B. The installation kit is thought to simplify the purchase of material for fitting the system, as much as possible. For systems in buildings with a standard layout, it is possible to have all the material available with the certainty of being able to complete the piping network without further additional installation material.

Warning

Only the installation material is included in the kit. The inlet valves are not included as they are part of the system and should therefore be selected from the right section of the catalogue.



Installation kit with **square mounting plates** (article no.1450.4B)

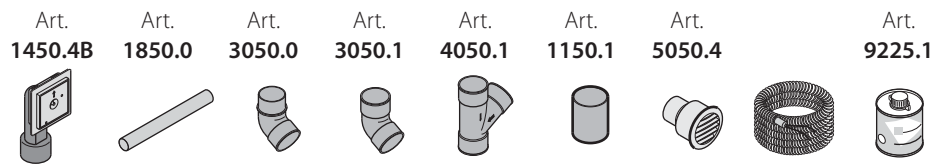

Article	No. of inlets	EC mounting plate Pieces	PVC pipe (m)	MF elbow Pieces	FF elbow Pieces	FF derivation Pieces	Coupling Pieces	Vent grate Pieces	Conduit (m)	Special glue Pieces
7030.3E	3	3	20	9	12	3	9	1	25	1
7030.4E	4	4	28	12	16	4	12	1	37,5	1
7030.5E	5	5	36	15	20	5	15	1	50	1



INSTALLATION MATERIAL

Rigid PVC piping and connectors especially designed for central vacuum systems to create a perfect fit between the piping and the connectors; only 45° connectors are provided to allow for the best possible air flow without creating the possibility of the system blocking.

NB: It is extremely important that the rigid PVC piping is cut using the appropriate tool (pipe cutter) and that the hold between the joints is guaranteed by using the special SISTEM-AIR glue in abundance, spreading it on the male and never on the female connector.

PVC piping

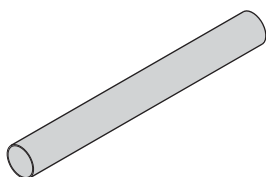

ARTICLE	DESCRIPTION	PACKING m
1850.0	Ø 50 2.2 mm thick PVC PIPE (2 m bars)	20
1863.0	Ø 63 3 mm thick PVC PIPE (2 m bars)	20
1880.0	Ø 80 3 mm thick PVC PIPE (2 m bars)	10
1810.0	Ø 100 3 mm thick PVC PIPE (2 m bars)	10

PVC 45° elbow

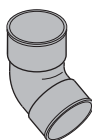
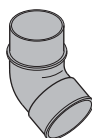

ARTICLE	DESCRIPTION	PACKING m
3050.0	Ø 50 45° male / female PVC elbow	60
3063.0	Ø 63 45° male / female PVC elbow	30
3080.0	Ø 80 45° male / female PVC elbow	1
3010.0	Ø 100 45° male / female PVC elbow	1
3050.1	Ø 50 45° female / female PVC elbow	60
3063.1	Ø 63 45° female / female PVC elbow	30
3080.1	Ø 80 45° female / female PVC elbow	1
3010.1	Ø 100 45° female / female PVC elbow	1

PVC 45° derivation

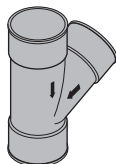
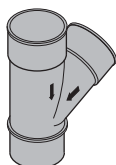

ARTICLE	DESCRIPTION	PACKING m
4050.0	Ø 50 45° male / female / female PVC DERIVATION	20
4063.0	Ø 63 45° male / female / female PVC DERIVATION	15
4080.0	Ø 80 45° male / female / female PVC DERIVATION	1
4010.0	Ø 100 45° male / female / female PVC DERIVATION	1
4050.1	Ø 50 45° female / female / female PVC DERIVATION	20
4063.1	Ø 63 45° female / female / female PVC DERIVATION	15
4080.1	Ø 80 45° female / female / female PVC DERIVATION	1
4010.1	Ø 100 45° female / female / female PVC DERIVATION	1



PVC coupling for linear junctions

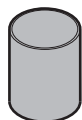

ARTICLE	DESCRIPTION	PACKING m
1150.1	ø 50 pvc stop coupling	100
1163.1	ø 63 pvc stop coupling	40
1180.1	ø 80 pvc stop coupling	1
1110.1	ø 100 pvc stop coupling	1

PVC pipe adapter

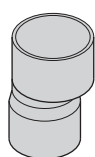

ARTICLE	DESCRIPTION	PACKING m
6063.3	ø 50/63 hose adaptor	1
8080.3	ø 63/80 hose adaptor	1
1010.3	ø 80/100 hose adaptor	1

PVC expansion joints

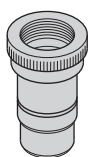

ARTICLE	DESCRIPTION	PACKING m
5050.0	ø 50 expansion joint	1
5050.2	ø 63 expansion joint	1

PVC screw caps for inspecting



ARTICLE	DESCRIPTION	PACKING m
5050.1	ø 50 pvc inspection screw cap	1
6063.1	ø 63 pvc inspection screw cap	1
8080.1	ø 80 pvc inspection screw cap	1
1010.1	ø 100 pvc inspection screw cap	1

Air vent grate

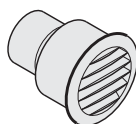

ARTICLE	DESCRIPTION	PACKING m
5050.4	ø 50 exhaust vent	1
5063.4	ø 63 exhaust vent	1

Air vent silencer

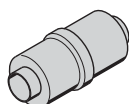

ARTICLE	DESCRIPTION	PACKING m
110001	standard ø 50 / 2" pvc silencer	1
110002	standard ø 63 pvc silencer	1



Special glue for PVC pipes

ARTICLE	DESCRIPTION	PACKING m
9225.1	250 g of special glue with brush	5
9225.2	500 g of special glue with brush	5
9500.0	500 g of special glue without brush	4

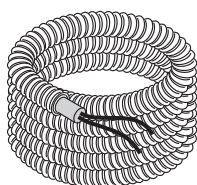

Pre-wired conduit 2 x 1 mm²

ARTICLE	DESCRIPTION	PACKING m
9016.7	2x1 mm ² (25 m) pre-wired conduit	1
9016.0	2x1 mm ² (50 m) pre-wired conduit	1
9016.1	2x1 mm ² (100 m) pre-wired conduit	1

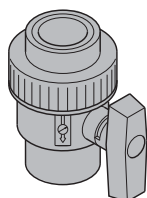

Ball valve for manual division

ARTICLE	DESCRIPTION	PACKING m
2050.0	ø 50 ball valve for manual division	1
2050.1	ø 63 ball valve for manual division	1
2050.2	ø 80 ball valve for manual division	1
2050.3	ø 100 ball valve for manual division	1

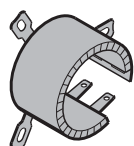

Fire stop coupling

ARTICLE	DESCRIPTION	PACKING m
1150.3	ø 50 fire stop coupling	1
1163.2	ø 63 fire stop coupling	1
1180.2	ø 80 fire stop coupling	1
1110.2	ø 100 fire stop coupling	1

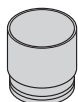

Screw cap for testing installation

ARTICLE	DESCRIPTION	PACKING m
5050.5	Screw cap for testing domestic system installations	5

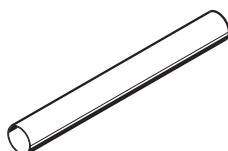

Alluminium pipE

ARTICLE	DESCRIPTION	PACKING m
1850.0A	Alluminium pipe alloy 6060; ø 50 - 2,2 mm Thick (3 m Bars)	9
1863.0A	Alluminium pipe alloy 6060; ø 63 - 2,2 mm Thick (3 m Bars)	9



Zinc-coated steel installation material

Rigid steel pipes and connections, built to guarantee endurance and electric transmission in all the contexts where these characteristics are essential for the correct installation.

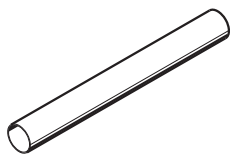
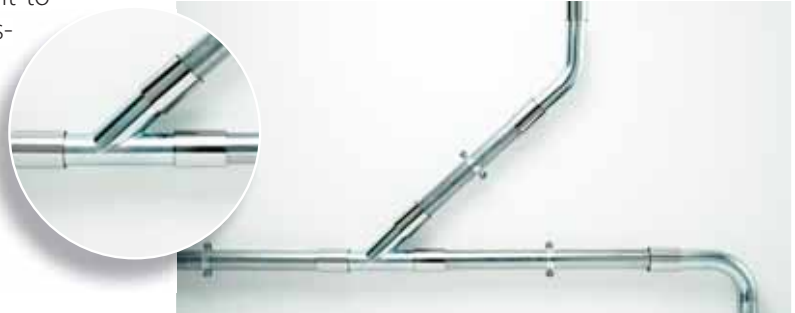

STEEL PIPE

ARTICLE	DESCRIPTION	PACKING m
1850.0F	Steel pipe Ø 50 (2 m bars)	1
1863.0F	Steel pipe Ø 60 (2 m bars)	1



45° ELBOW PIPE

ARTICLE	DESCRIPTION	PACKING m
3050.1F	Elbow pipe 45° Male /Male Ø 50	1
3063.1F	Elbow pipe 45° Male /Male Ø 60	1

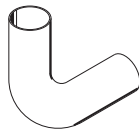

90° ELBOW PIPE

ARTICLE	DESCRIPTION	PACKING m
3050.0F	Elbow pipe 90° Male /Male Ø 50	1
3063.0F	Elbow pipe 90° Male /Male Ø 60	1

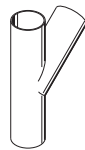

45° DERIVATION PIPE

ARTICLE	DESCRIPTION	PACKING m
4050.0F	Derivation pipe 45° Male /Male / Male Ø 50	1
4063.0F	Derivation pipe 45° Male /Male / Male Ø 60	1

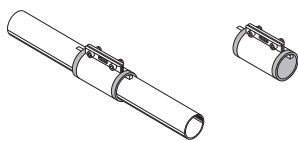

JUNCTION GROUPS

ARTICLE	DESCRIPTION	PACKING m
1150.1F	Junction group steel pipe Ø 50	5
1163.1F	Junction group steel pipe Ø 60	5

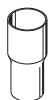

STEEL ADAPTER

ARTICLE	DESCRIPTION	PACKING m
6050.0F	Steel adapter Ø 50/60	1

Back plate inlets

The standard rectangular mounting plates with elbow connector are suitable for all the inlet valves that accept decorative frames, while the square mounting plates are suitable for the inlet valves already complete with aesthetic finishing in three different colours (white, ivory or silver).

All models have set notches for the prewired cable.

STANDARD SQUARE MOUNTING PLATE

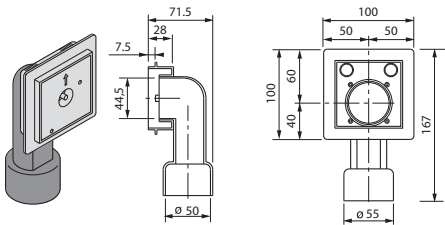

ARTICLE	DESCRIPTION	PACKING m
1450.4B	STANDARD MOUNTING PLATE elbow connector with cover	10

STANDARD SQUARE MOUNTING PLATE

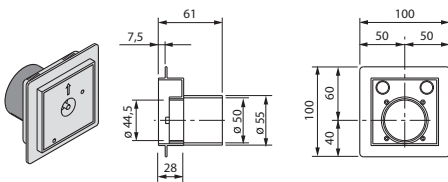

ARTICLE	DESCRIPTION	PACKING m
1450.5B	STANDARD MOUNTING PLATE straight connector with cover	10

FLOOR MOUNTING PLATE

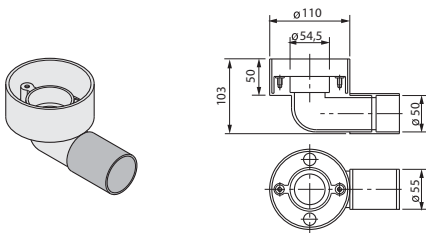

ARTICLE	DESCRIPTION	PACKING m
1450.2	FLOOR MOUNTING PLATE elbow connector	1

FLOOR MOUNTING PLATE

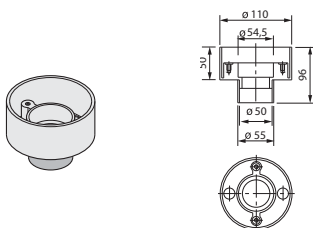

ARTICLE	DESCRIPTION	PACKING m
1450.3	MOUNTING PLATE straight connector	1



ROUND MOUNTING PLATES

The round mounting plates are suitable for all inlet valves, which have been projected for the installation on plasterboards with the thickness of 12 mm or 24 mm. All models have set notches for the pre-wired cable.

N.B. Mounting plates suitable for use with Ø 50 pipes.

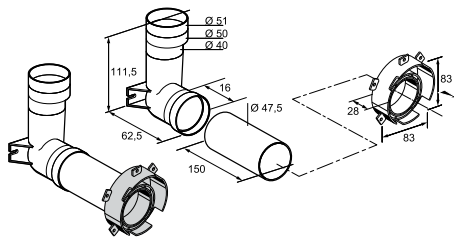

Back plate kit for plasterboard (for square inlets)*

ARTICLE	DESCRIPTION	PACKING m
1450.4C	ROUND BACK PLATE square inlets	1

*For Ø 40/50/51 mm piping

ROUND MOUNTING PLATES

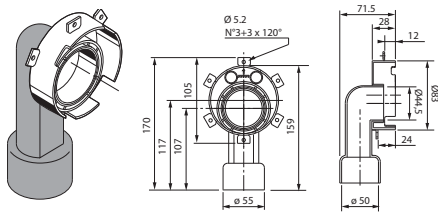

ARTICLE	DESCRIPTION	PACKING m
1450.13	ROUND MOUNTING PLATE elbow connector	10

ROUND MOUNTING PLATES

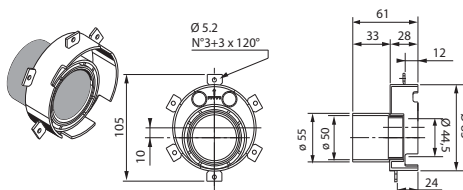

ARTICLE	DESCRIPTION	PACKING m
1450.12	ROUND MOUNTING PLATE straight connector	10

MOUNTING PLATE FOR VACPAN INLET VALVE

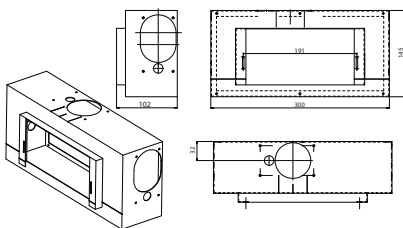

ARTICLE	DESCRIPTION	PACKING m
1450.16	STEEL MOUNTING PALTE for vacpan inlet valve	1

EXTENSION KITS FOR MOUNTING PLATE AND INLET VALVE

The mounting plate extension kit represents a real innovation in the sector. Thanks to this innovation, it is possible to extend the wall box by multiples of a centimetre without size limitations: the flat inlaid box ensures simple installation and a perfect hold of the inlet valve.

N.B. Each extension kit is fitted with 3 frames of 1 cm each, a 3 cm inlet valve extension and a pack of screws. Kits can be added until you have the measurement required.



3 cm EXTENSION

ARTICLE	DESCRIPTION	Packing pieces
1457.1	Extension for domestic inlet valves	5

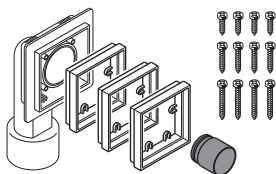

3 cm EXTENSION KIT

ARTICLE	DESCRIPTION	Packing pieces
1450.9	Extension kit for square mounting plate	10





Switch on your vacuum cleaner with



great technology, full lightness

Lifetime guarantee for electronic components

Same comfort of traditional on-off hose but
no limitation as no electric wiring inside!

Reliable, comfortable, light



FLISY, THE CLEANING INNOVATION

Sistem Air has created Flisy, the innovative flexible hose with wireless technology, that combines the lightness of a traditional hose with the comfort of the ON-OFF switch on the handgrip.



FLISY: A CONCENTRATION OF ADVANTAGES



Wireless

- **COMFORTABLE:** you can start up and stop your central vacuum cleaner by pressing the button on the handgrip: this gives you maximum freedom during your cleaning activities.



ON - OFF
REMOTE

- **RELIABLE:** many checks on the electronic components realized the life time guarantee: this is the Sistem Air quality.



Long Lasting
BATTERY

- **LIGHT:** the electric wire which used to be installed in the flexible hose has been eliminated, granting the comfort of the ON-OFF wire, with a weight reduction of about 40% respect to the traditional ON-OFF hose.

- **STRONG:** thanks to the elimination of the electric wire, it is more flexible: this means more strength and more length.

- **UNIVERSAL:** Flisy is compatible with the main inlets with electric connection on sale.

- **SMART:** its technology avoids an accidental use of the system, because the vacuum units starts cleaning only when the hose is inside the inlet.

- **ERGONOMIC:** the handgrip has been designed to offer an extreme ease of handling, thanks to its lightness.



360°

- **HANDLY:** Both handgrip and fitting cuff rotate at 360°, allowing high ease of movement.

Wireless hose
Flisy m 7
1.703 g



Traditional on-off
hose m 7
2.985 g



Package Art. 7039.0W



Accessory kits with ON-OFF Flisy

Accessory kits ON-OFF

Accessory kits Ø 32 mm







Wireless

The Flisy accessory kits represent an innovation: a light and comfortable hose without internal wiring though with the comfort of the wireless system. You can switch on or off the central unit directly on the handgrip. There are six accessory kits available in different combinations. The elegant package contains several accessories for all cleaning activities.

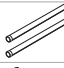

ARTICLE 7030.7W	Wireless accessory kit 7m with on-off	BASIS
------------------------	---------------------------------------	--------------

ARTICLE 7030.9W	Wireless accessory kit 9 m with on-off	
------------------------	--	--

	Article	Description	Qty
	7037.7	7 m hose	1
	7039.0W	Wireless handgrip Connector Flisy	1
	7040.0	Pair of chrome pipes	1
	7047.1	30 cm floor brush	1











ARTICLE 7031.7W	Wireless accessory kit 7 m with on-off	ELITE
------------------------	--	--------------

ARTICLE 7031.9W	Wireless accessory kit 9 m with on-off	
------------------------	--	--

	Article	Description	Qty
	7041.0	Accessory holder (10 pieces)	1
	7037.7	7 metre hose	1
	7039.0W	Wireless handgrip Connector Flisy	1
	7040.1	Chrome telescopic pipe	1
	7047.1	30 cm floor brush	1
	7036.0	Dual purpose brush	1
	7043.0	Brush for dusting	1
	7046.0	Radiator brush	1
	7042.0	Brush for clothes	1
	7044.0	Brush for mattresses - upholstery	1
	7045.0	Crevice tool	1

ARTICLE 7032.7W	Wireless accessory kit 7 m with on-off	STANDARD
------------------------	--	-----------------





ARTICLE 7032.9W	Wireless accessory kit 9 m with on-off	
------------------------	--	--









	Article	Description	Qty
	7041.0	Accessory holder (10 pieces)	1
	7037.7	7 m hose	1
	7039.0W	Wireless handgrip Connector Flisy	1
	7040.0	Pair of chrome pipes	1
	7047.1	30 cm floor brush	1
	7043.0	Brush for dusting	1
	7046.0	Radiator brush	1
	7042.0	Brush for clothes	1
	7044.0	Brush for mattresses - upholstery	1
	7045.0	Crevice tool	1

Ø 32















Complete accessory kit

Cleaning accessory kit Ø 32 mm without on-off.
When you insert the hose in the suction inlet, the central unit starts up.

ARTICLE 7032.4	Accessory kit 7 m without on-off		BASIS
	Article	Description	Qty
	7037.7	7 metre hose	1
	7038.0M	Wall end swivel connector	1
	7039.1	Handgrip with air regulation (plastic)	1
	7040.0	Pair of chrome pipes	1
	7047.1	30 cm floor brush	1

ARTICLE 7030.0	Accessory kit 7 m without on-off		MINI
	Article	Description	Qty
	7041.1	Accessory holder (4 pieces)	1
	7037.7	7 metre hose	1
	7038.0M	Wall end swivel connector	1
	7039.1	Handgrip with air regulation (plastic)	1
	7040.2	Pair of plastic pipes	1
	7047.1	30 cm floor brush	1
	7043.0	Brush for dusting	1
	7045.0	Crevice tool	1

ARTICLE 7032.0	Accessory kit 7 m without on-off		STANDARD
ARTICLE 7032.2	Accessory kit 9 m without on-off		
	Article	Description	Qty
	7041.0	Accessory holder (10 pieces)	1
	7037.7	7 metre hose	1
	7038.0M	Wall end swivel connector	1
	7039.1	Handgrip with air regulation (plastic)	1
	7040.0	Pair of chrome pipes	1
	7047.1	30 cm floor brush	1
	7043.0	Brush for dusting	1
	7046.0	Radiator brush	1
	7042.0	Brush for clothes	1
	7044.0	Brush for mattresses - upholstery	1
	7045.0	Crevice tool	1

ARTICLE 7031.0	Accessory kit 7 m without on-off		ELITE
ARTICLE 7031.2	Accessory kit 9 m without on-off		
	Article	Description	Qty
	7041.0	Accessory holder (10 pieces)	1
	-	6 meter hose	1
	-	2 meter hose	1
	7038.0M	Wall end swivel connector	1
	7048.0	Extension pipe connector	1
	7039.0	Chrome elbow connector	1
	7040.1	Chrome telescopic pipe	1
	7047.1	30 cm floor brush	1
	7036.0	Dual purpose brush	1
	7043.0	Brush for dusting	1
	7046.0	Radiator brush	1
	7042.0	Brush for clothes	1
	7044.0	Brush for mattresses - upholstery	1
	7045.0	Crevice tool	1



Our accessories

Cleaning your home has never been so easy: the accessories of Sistem Air can clean every kind of surface with amazing results!



Art 7039.0W
Impugnatura e raccordo presa Wireless Flisy



Art. 7047.0 (lunghezza 37 cm)
Art. 7047.1 (lunghezza 30 cm)
Floor brush



Art 7036.0
Multi use brush for use on timber floors, tiles & carpet



Art 7035.0
Felt brush for timber floors



Art 7044.0
Brush for mattresses and upholstery



Kit wireless standard



Art 7043.0 (tubo Ø 32 mm)
Dusting brush



Art 7049.0
Brush for pets



Art. 7045.0 (tubo Ø 32 mm)
Crevice tool



Art 7046.0
Brush for radiators



Art. 7033.1 (tubo Ø 32 mm)
Brush for liquids



Art 7042.0
Clothes brush



Art 7033.0
Liquid separator in PVC C/ accessori



Art 7033.7
Ash separator in metallo



Art 7037.1 (lunghezza 7 m)
Art 7037.4 (lunghezza 10 m)
Sock for flexible hose



Art 7033.3
Turbo brush for rugs carpets



Art 7034.0
Turbo brush for carpets

The accessory kits of Sistem Air, provided in a single pack, are offered in several variations to satisfy any possible cleaning needs.



Our vacuum inlets



Special inlets

Vacpan

Art 1464.2
white colour



Art 1464.3
black colour



Art 1464.5
silver colour



For external use

Art 1459.5



Industrial

Art 1456.1



floor suction inlets

Art 1455.0A
Art 1455.0N



Square suction inlets

Matching square back plate

Art 1464.0B

Art 1464.1B

Art 1464.2B



- HYGIENIC
- SAFE
- QUIET
- COMFORTABLE
- COMPLETE
- VERSATILE

... all in a single system



System Air



central vacuum system...
go for it!



A series of horizontal dotted lines for writing notes.



www.sistemair.com

